

InTouch Vantage™ Quick Reference Guide

Operating the Vantage

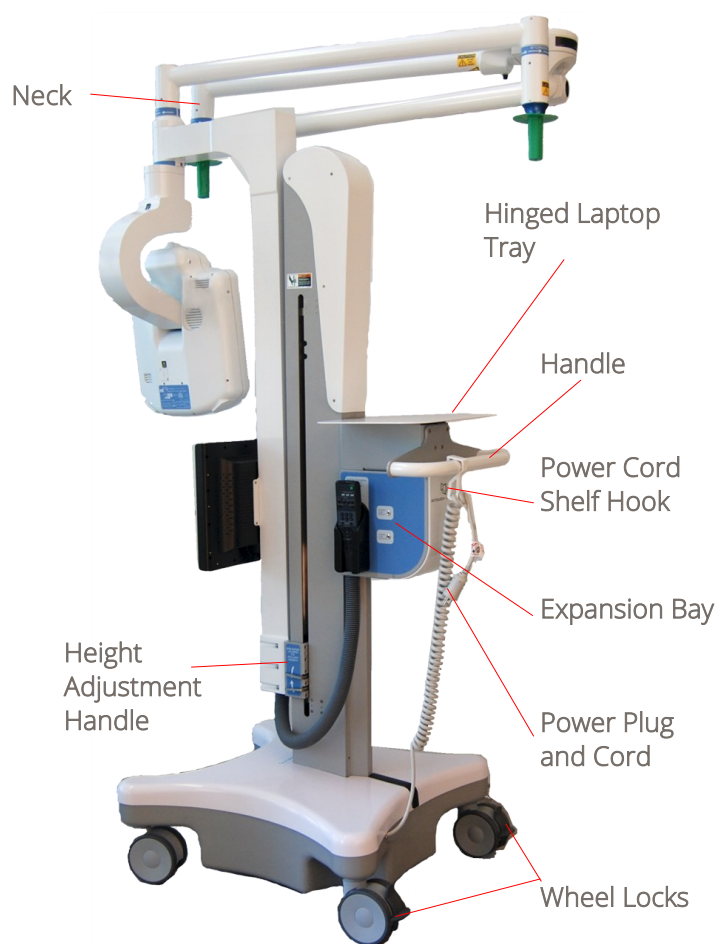

Vantage Button Panel

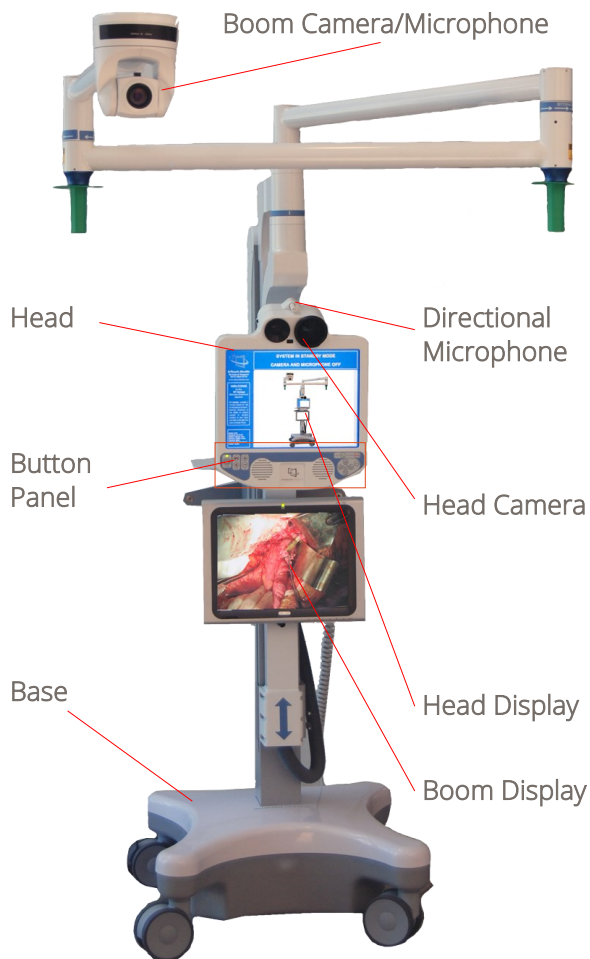
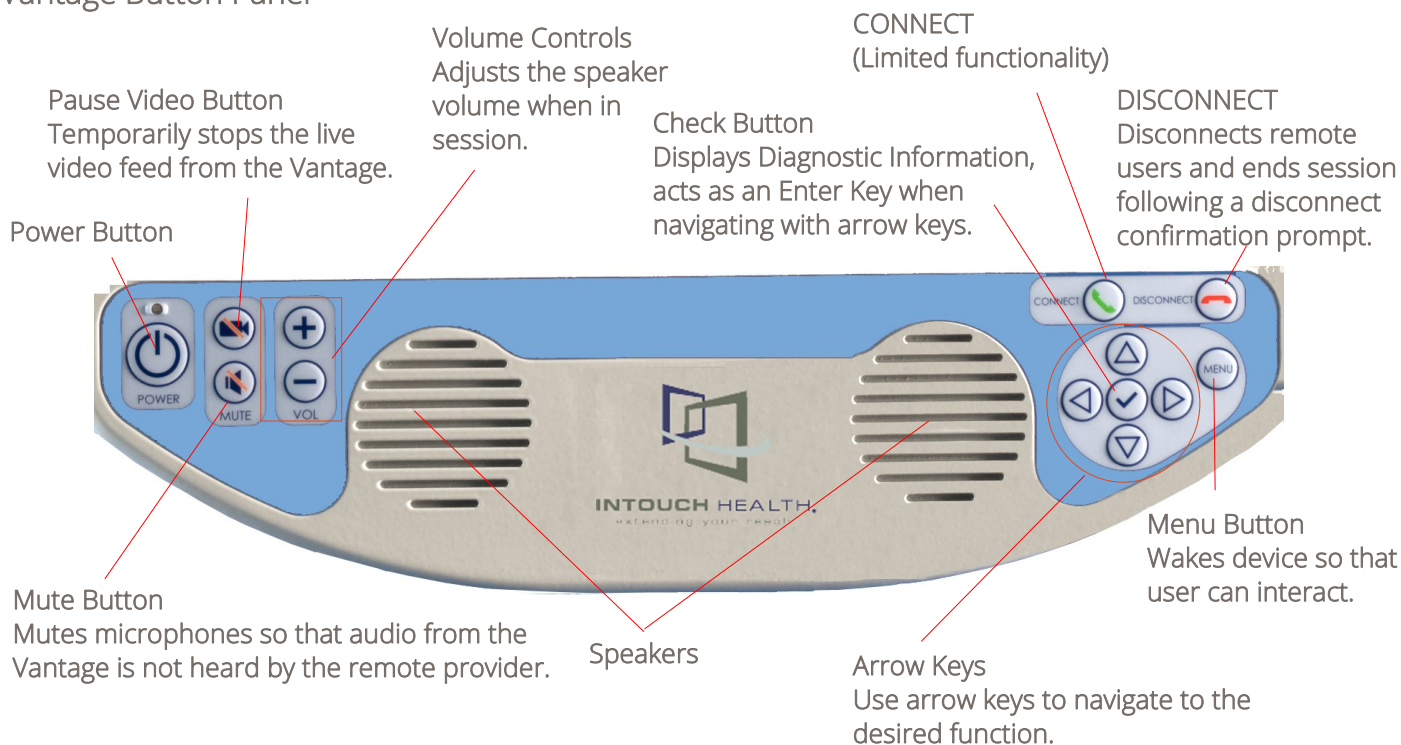

InTouch Vantage™ Quick Reference Guide

Moving the Vantage

The Vantage is designed to be movable by hospital staff.

- Ensure that Boom is completely folded.
- Ensure that Head is set at its lowest position.
- Ensure that the power cord is unplugged.
- Ensure that the wheels are unlocked before moving.
- Exercise caution when encountering thresholds.
- Move to the desired location.
- Lock the wheels.
- Plug in the power cord.

CAUTION: Force from above – Observe the overhead Boom when moving or adjusting the position of the Vantage. Overhead objects such as lights, can be damaged by unexpected collisions.

CAUTION: Do not pull down or place any heavy objects on the Boom, especially when the Boom is extended.

CAUTION: The Vantage is a large and heavy piece of equipment. As such, caution must be exercised to avoid collision with persons, inanimate objects, and critical equipment when moving or re-positioning during use or transport.

CAUTION: Avoid the labeled pinch points on the Vantage, especially operating the lifting mechanism, extending or folding the Boom, and during remote sessions when the Vantage head and the Boom camera can be moved remotely.

Extending and Folding the Boom

CAUTION: Do not connect any Auxiliary equipment to the Vantage in such a way as to cause or lead to a sterile field being penetrated if the Vantage is moved (remotely or otherwise).

CAUTION: Force from above – Observe the overhead Boom when moving or adjusting the position of the Vantage. Overhead objects such as lights, can be damaged by unexpected collisions.

CAUTION: Do not pull down or place any heavy objects on the Boom, especially when the Boom is extended.

CAUTION: Avoid the labeled pinch points on the Vantage, especially operating the lifting mechanism, extending or folding the Boom, and during remote sessions when the Vantage head and the Boom camera can be moved remotely.

CAUTION: The Vantage is not being provided sterile and any potential peripherals attached to the Vantage may not be provided sterile. The Vantage Boom can be extended up to 146 inches ahead measured from the back of the handle.

- Ensure that Head is set at its lowest position.
- Lock the wheels.
- Pull the handles to rotate the joints of the Boom into the approximate position required. The arrows indicate the direction to rotate the arms when folding the Boom.

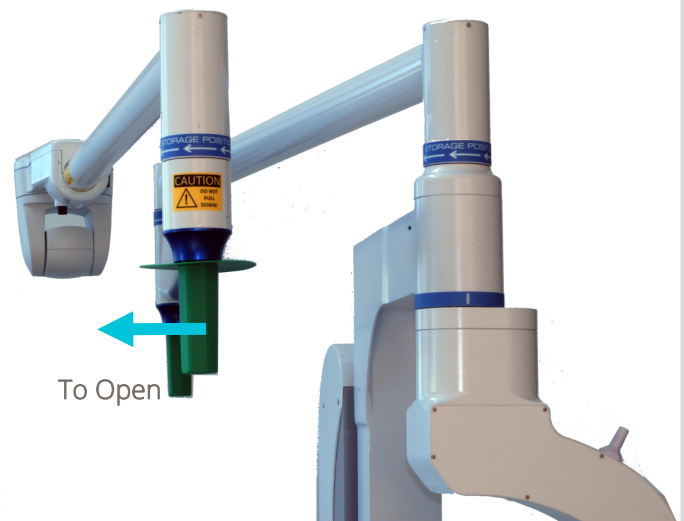
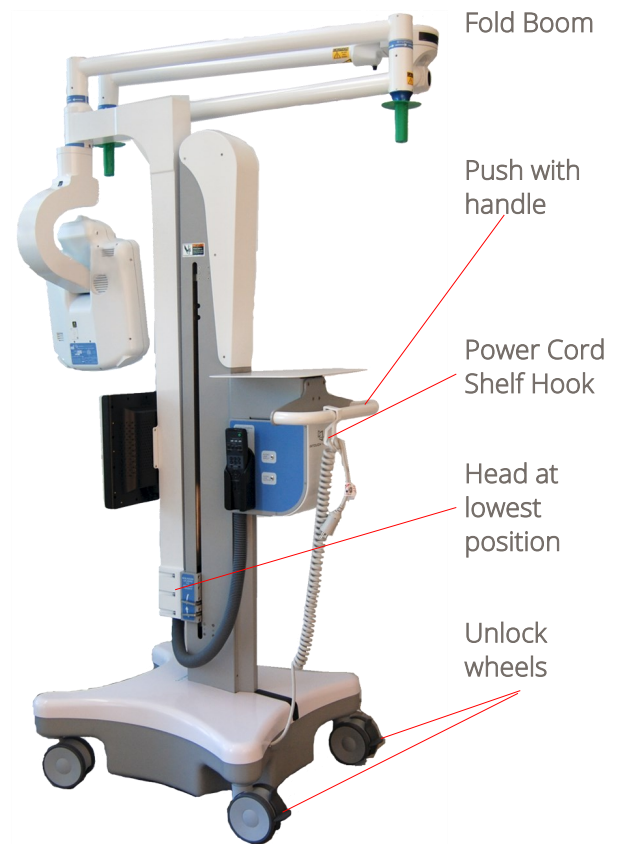

InTouch Vantage™ Quick Reference Guide

- Adjust the Boom Camera location by grasping the boom at the Boom Camera.

Adjusting the Height

CAUTION: Force from above – Observe the overhead Boom when moving or adjusting the position of the Vantage. Overhead objects such as lights, can be damaged by unexpected collisions.

CAUTION: Do not pull down or place any heavy objects on the Boom, especially when the Boom is extended.

CAUTION: Avoid the labeled pinch points on the Vantage, especially operating the lifting mechanism, extending or folding the Boom, and during remote sessions when the Vantage head and the Boom camera can be moved remotely.

CAUTION: The Vantage is not being provided sterile and any potential peripherals attached to the Vantage may not be provided sterile.

The Vantage Boom can be placed between 80 inches and 111 inches off the floor.

- Squeeze the levers and raise or lower the Boom height.



2. Squeeze levers and pull up or push down.

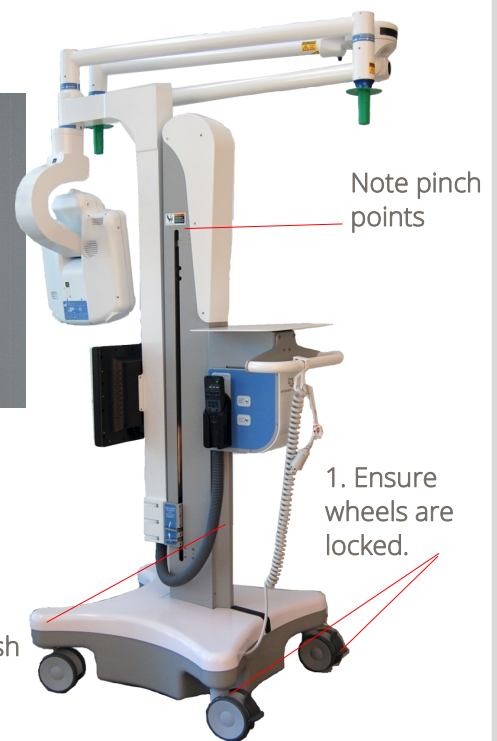

Boom Camera

The Boom Camera system is powered whenever the Main power is on. If either the Camera or the Display is turned off, the power light will be orange and the component must be turned on.

Boom Camera Remote Commander

The Boom Camera Remote Commander allows you to control the Boom Camera at times when the Vantage computer is not powered or when a Provider Access Software login is not available.

CAUTION: Do not use the Boom Camera Remote Commander during an active session.

- Ensure Boom Camera is on.
- Press Camera Select #1.
- Use PAN-TILT and ZOOM to get the desired view.

Refer to the *Sony EVI-D70 Color Video Camera Operating Instructions* and the *LCD Display CD-ROM* for important information and operating and user maintenance procedures.

Menu Button

Pressing the Menu button will enable out of session interaction with the Vantage. Use the arrow keys to navigate to the desired function, and press the Check button to select.



InTouch Vantage™ Quick Reference Guide

Power On Sequence

The Vantage should be plugged in and left powered on at all times.

1. Plug in the power cord:

Ensure that the power cord is plugged into an approved wall socket.

2. Turn On the Main Power at the Expansion Bay:

Press and hold (3-5 sec.) the main power button. Ensure that the power light is lit.

CAUTION: To ensure system readiness, connectivity, and charged batteries, power on the Vantage Display at least two hours before its intended use.

3. Turn On the Power at the Button Panel:

Press the Power button once.

After a short period of self-testing (1-2 minutes), a screensaver should appear on the display.

4. Turn on the Boom Camera, if required:

Change to: If the Boom Camera has been turned off, the STANDBY light will be orange; the Camera is in standby and will need to be turned on.

Press the power button on the Remote Commander while pointing at the Boom Camera. The power light should be green.

5. Turn on the Boom Camera Display, if required:

If the Boom Camera Display has been turned off, you are powering the Vantage for the first time, or the Vantage has been in storage, you may need to turn on the display. If the power light is orange, the display is in standby and will need to be turned on.

Press the power button on the bottom, right edge of the display. The power light should light green.

Check to ensure the display powers up successfully.

Power Off Sequence

CAUTION: Only power off this device when instructed by InTouch Technical Service.

1. Turn off the power at the button panel:

Press the power button once.

Press the check button within seven seconds after the "Do Not Turn Off" message appears.

Confirm shutdown as indicated by the screen going black after approximately 30-45 seconds.

2. Turn off the main power at the expansion bay:

Press and hold (3-5 sec) the main power button.

