

Junkrig for a Kelt 8.50

This junkrig was designed for **Ketil Greve**'s Kelt 8.50, in Stavanger. Ketil made the sail and got the rig operational in the spring of 2021.

The design of the sail is based on the Johanna-style master sail with $AR=1.90$. In fact, the lower four panels are direct 1:1 copy of the sail of my *Ingeborg*. The 3-panel top section has been modified to take a 60° yard, still with each panel of the same area as in the lower one. The reason for the lower yard angle was to fit the aft-set mast position. The sail is now setting with at least 22% mast balance, and with a near-vertical halyard.

The sail is rigged without a *Throat Hauling Parrel*, THP, only with *Yard Hauling Parrel*, YHP, and Hong Kong parrels (..plus batten parrels, of course...). I guess the upper batten parrel prevents the sail from shifting too far forward.

The sail looks good in action and appears to perform well, despite its moderate size.

Stavanger, 17th Dec. 2021,

Arne Kverneland

Note:

lomme = pocket

spile = batten

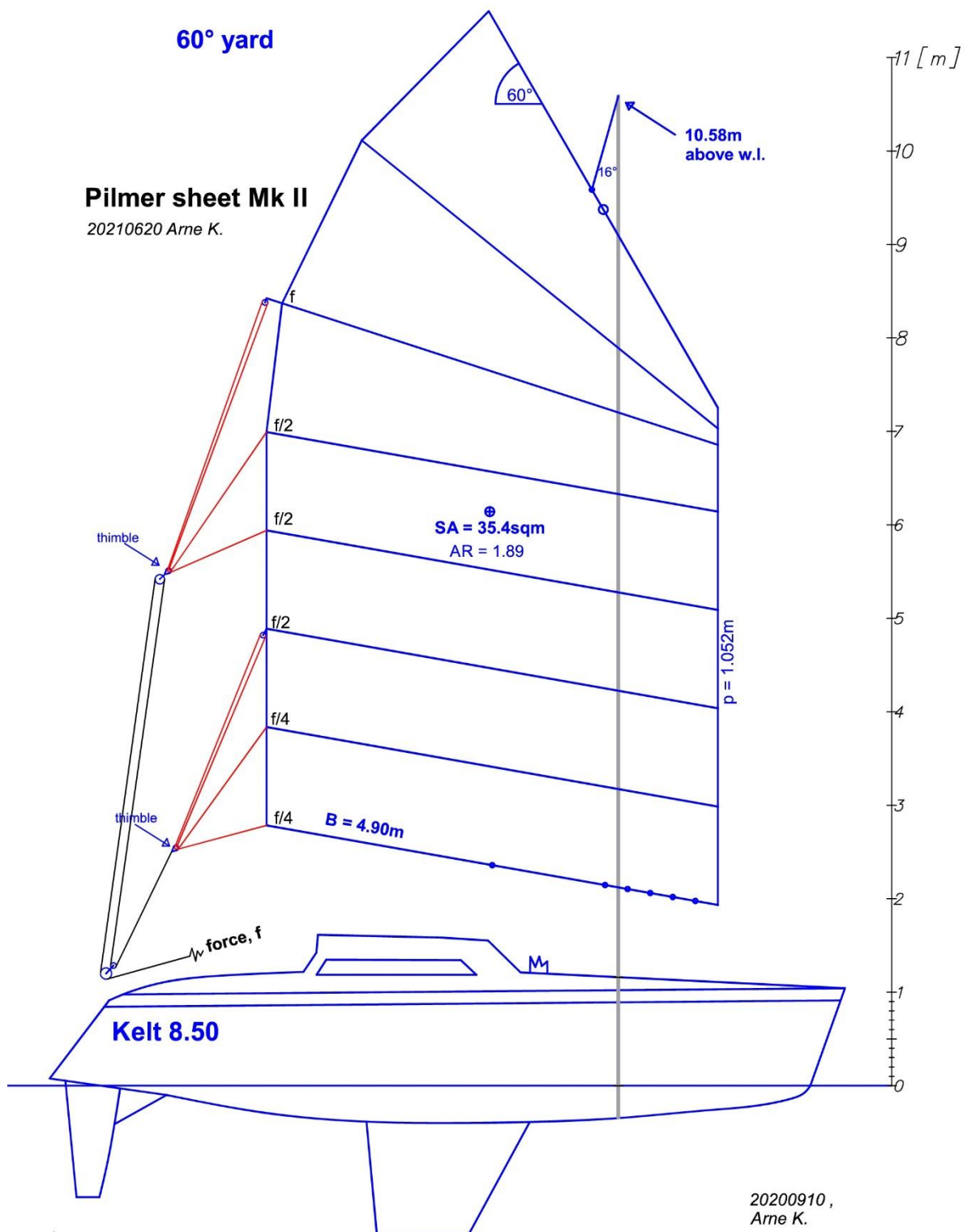

Kelt 8.50

60° yard

SA = 35.4sqm

AR = 1.89

Omkrets 24.6m

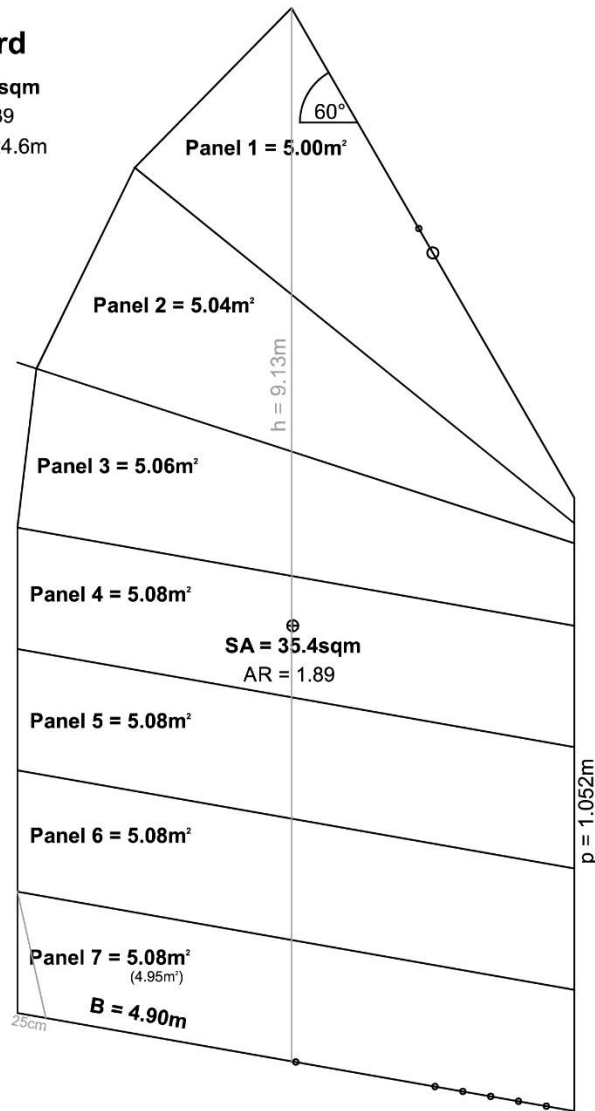

Junkrig for a Kelt 8.50

B=4.90m, h=9.13m

SA=35.4m, AR=1.89

Sheet 1

28.1.2021, Arne Kverneland

Kelt 8.50

m/rå-vinkel 60°

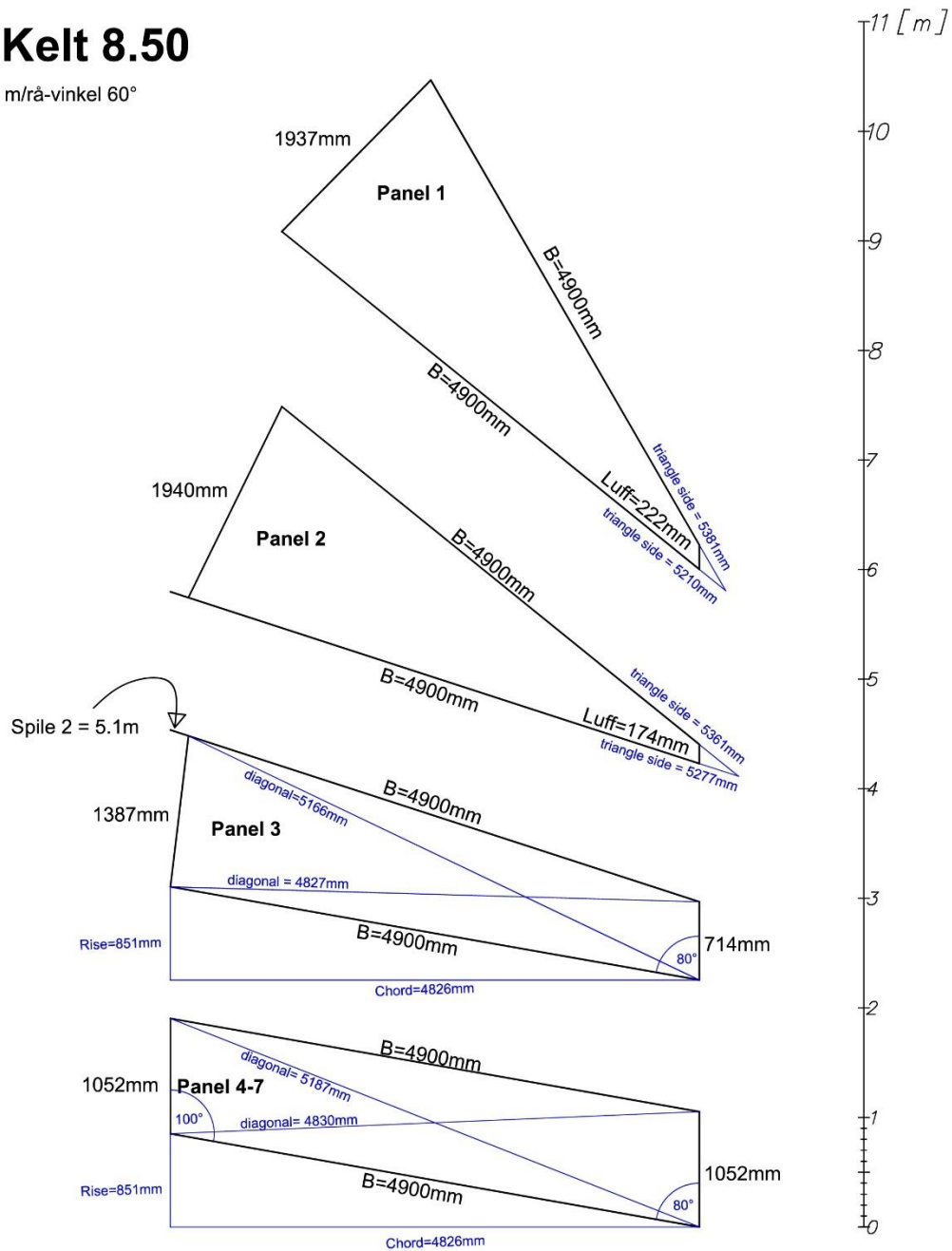

Junkrig for a Kelt 8.50
 B=4.90m, h=9.13m
 SA=35.4m, AR=1.89

Sheet 2

28.1.2021, Arne Kverneland

Kelt 8.50

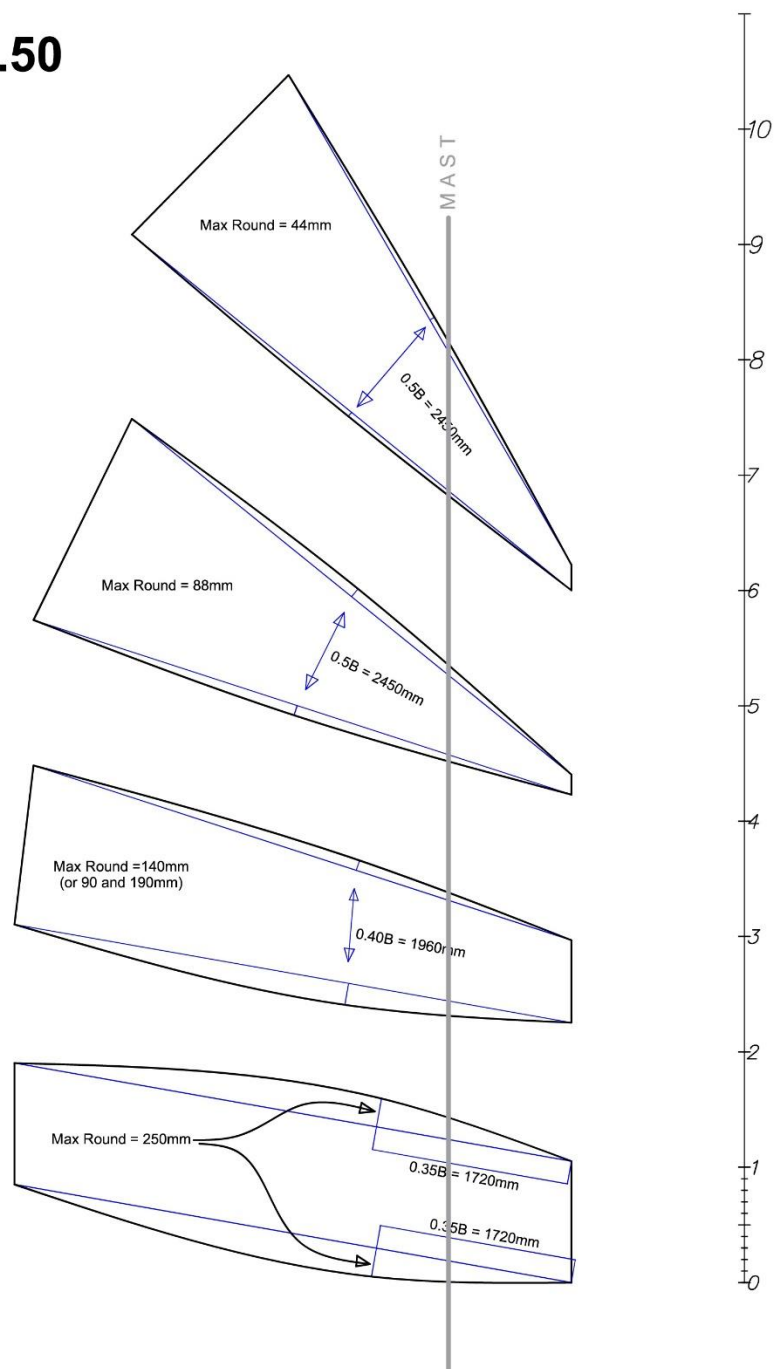

Junkrig for a Kelt 8.50
 $B=4.90m$, $h=9.13m$
 $SA=35.4m$, $AR=1.89$

Sheet 3

28.1.2021, Arne Kverneland

Kelt 8.50

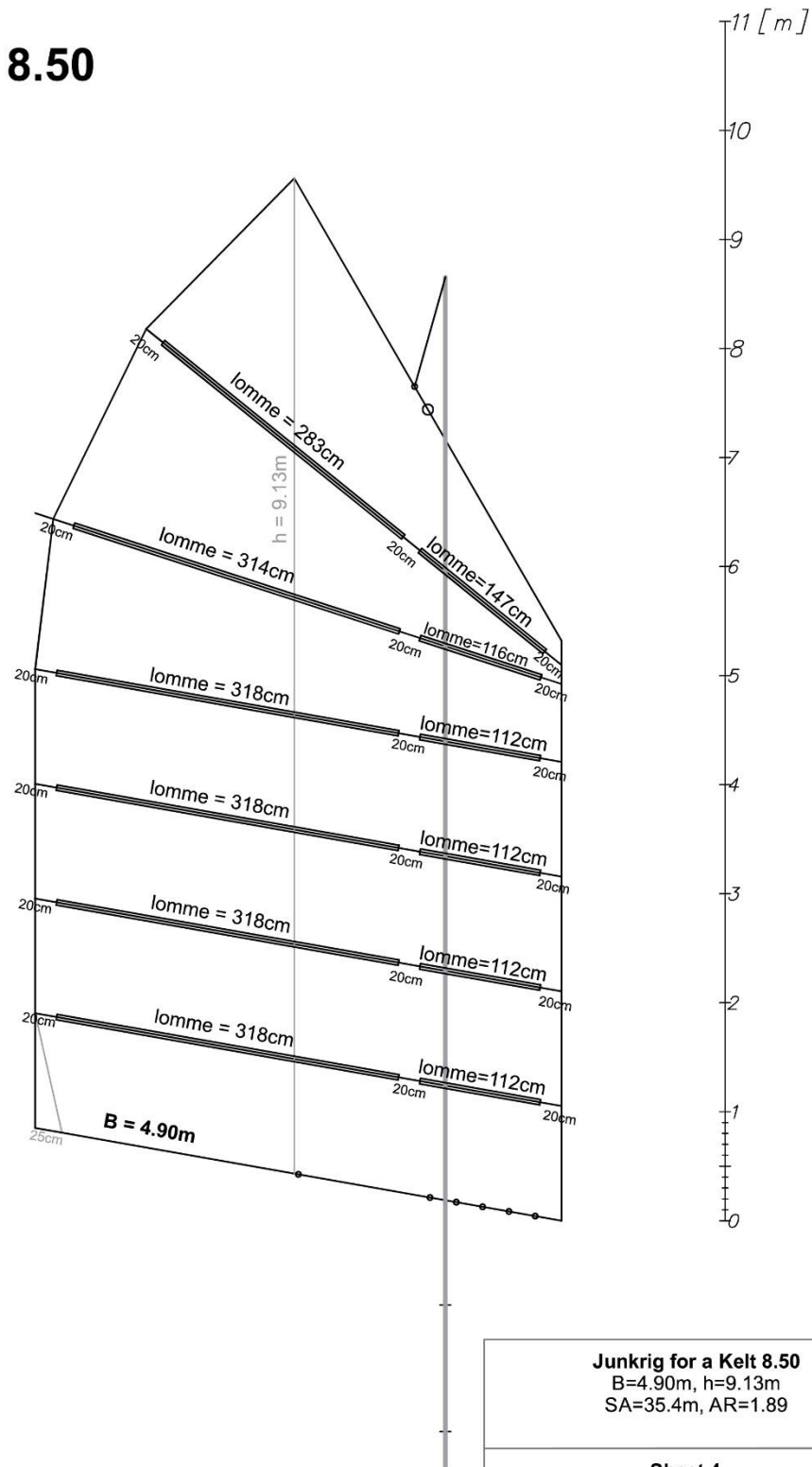

Junkrig for a Kelt 8.50
 $B=4.90m$, $h=9.13m$
 $SA=35.4m$, $AR=1.89$

Sheet 4
 28.1.2021, Arne Kverneland

