

Product Instruction

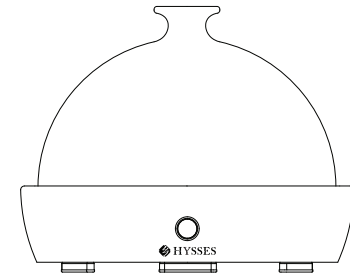

DOME - Ultrasonic Water Mist

Indulge in a nature escapade in the comfort of your room simply with our Ultrasonic Water Mist Dome.

After-Sales Warranty & Checklist

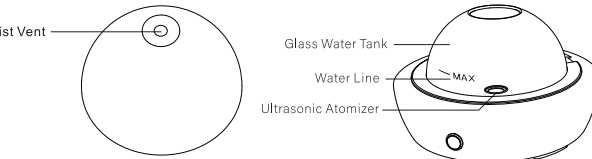
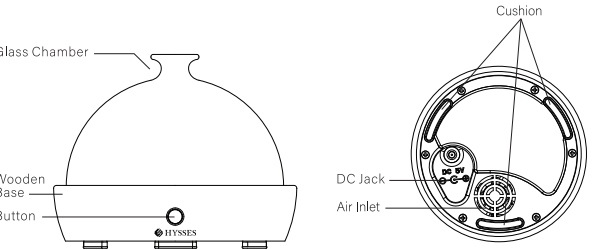

Checklist

- | | | |
|--|------------------------------------|--|
| <input type="checkbox"/> Glass Chamber | <input type="checkbox"/> Adapter | <input type="checkbox"/> Instruction Booklet |
| <input type="checkbox"/> Wooden Base | <input type="checkbox"/> USB Cable | <input type="checkbox"/> Warranty Card |

*Registration of Warranty Online www.barnandpotter.com/warranty within 7 days of purchase in order to activate warranty protection for this purchase

Product Introduction

Dome Ultrasonic Water Mist uses ultrasonic frequencies to create vibrations on the water surface. The vibration creates negative ions and vaporises essential oil into micro droplets. The micro droplets are able to stay suspended in the air for longer periods of time, maximising the scenting effects and therapeutic benefits of essential oil. Negative ions clear the air of dust and allergens, normalises your breathing rate, decreases blood pressure, and relieves tension. Regular usage of the Ultrasonic Water Mist allows for better sleep, elevated mental performance, and health realignment.

Operating of Ultrasonic Water Mist:

- 1) Plug in, or ensure that the battery is fully charged.
- 2) Press the first time: Switch on the mist and light.
- 3) Press the second time: Switch off the lights.
- 4) Press the third time: Switch off the power.

Status Display

Charging mode: Red light will flash.

Fully charged mode: Red light will turn green.

- ✗ The Ultrasonic Water Mist can be used during charging, and the mood light will change colours.
- ✗ With rechargeable battery, it takes about 3.5 hours to fully charge, which can last for approximately 5 hours. (* Misting varies with the level of humidity in the environment.)
- ✗ It will switch off automatically when water runs out.

⚠ Notes

- 1) Do not use overloaded power outlet, damaged power cable or adapter, or it may pose threat to your safety. Avoid placing near areas that are fire hazard.
- 2) Do not attempt to revise, tear down or repair the product. Send to any of the HYSSES retail outlet to seek advice. (*Repair charges are applicable for machines not covered under warranty.)
- 3) Please maintain and clean the product regularly to ensure best working condition. Please refer to the Cleaning and Maintenance instruction.

Quick User Manual



Insert the USB cable into the DC jack from bottom.



Remove the glass chamber.

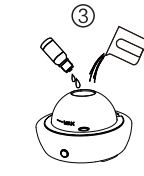

Add water and essential oil.



Cover with the lid.



Plug into a power supply with the adapter. Once it's fully charged, you may use it without connecting to a power supply.



Press the button to on the device.

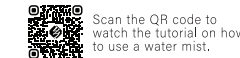

Scan the QR code to watch the tutorial on how to use a water mist.

Cleaning & Maintenance

To ensure product is in good condition, it is recommended to do a thorough cleaning and maintenance for the machine on weekly basis using the following steps:

- 1) Remove the USB cable from the diffuser, hold the base with one hand, hold the water tank cover with the other, lift it upwards, and open the water tank cover (as shown below).

* When opening the cover, please make sure to place the water mist on a flat surface to prevent it from falling.



- 2) Drain the remaining water.
- 3) Use 20 ml of HYSSES Cleaning Solution to rinse the glass chamber. ***Caution:** Don't directly touch or press the ultrasonic plate at the bottom center of the water tank.
- 4) After cleaning, add tap water and switch on the machine for 30 minutes. Drain, wipe and dry thoroughly.
- 5) To remove essential oil or dirt adhered to the outside of the unit cover or water tank, wet a cloth with HYSSES Cleaning Solution and wrung well.
- 6) If dirt accumulates near the nozzle, remove the unit cover and wash with HYSSES Cleaning Solution. Hold the tank cover and shake to remove the water inside, dry it before the next use.
- 7) Make sure that no hair or dust is on the air intake filter at the bottom. Use a cotton swab to remove any hair or dust. ***Caution:** The filter cover cannot be removed.

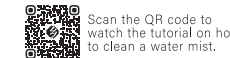

Scan the QR code to watch the tutorial on how to clean a water mist.

Specification

Product Size	Φ160x123mm
Weight	Approx. 760g
Power: Input/Output	AC100-240V 50/60Hz / DC 5V/2A
Tank Capacity	200ml
LED Light	Colorful light
Materials	Wood and glass
Noise Level (dB)	≤ 35 dB
Rate of Vibration	3.5MHz
Power	10W
Battery Capacity	4400mAh
Coverage	50-400 SQF

Warranty

To activate your warranty, please refer to the warranty card provided. If you purchased the diffuser in-store, our retail staff will assist with registering your warranty. For online orders, simply send the following details, along with a photo of your warranty card, to online.orders@hysses.com:

Full name
Email
Contact number
Order number

Once we receive your information, your warranty will be successfully activated.

产品使用说明书

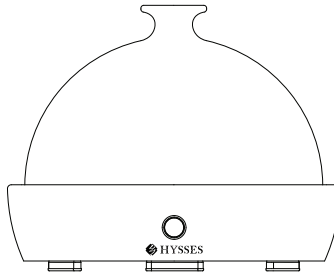

DOME - 香薰雾化仪

DOME 香薰雾化仪 带您探索大自然的奇妙之旅

售后保修与检查清单

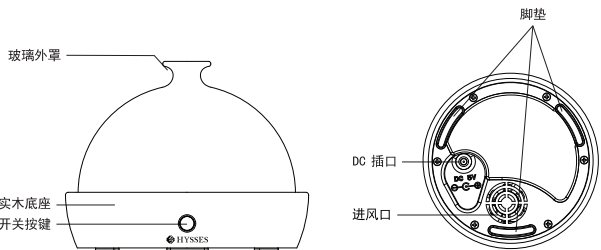

Checklist

- | | | |
|-------------------------------|----------------------------------|--------------------------------|
| <input type="checkbox"/> 玻璃外罩 | <input type="checkbox"/> 变压器 | <input type="checkbox"/> 使用说明书 |
| <input type="checkbox"/> 实木底座 | <input type="checkbox"/> USB 连接线 | <input type="checkbox"/> 保修卡 |

* 请参照附件中的保修卡，并在购买日起的7天内于www.barnandpotter.com/warranty上注册并填写保修单。

产品简介

DOME香薰雾化仪运用了超声波技术,通过在水面振动的频率产生了负离子同时使精油雾化成为微米级的水粒子。这些水粒子能在空气中停留更长的时间,使精油的芳香与功效发挥到极致。负离子能清除空气中的尘埃和降低过敏的风险,调节您的呼吸频率,降低血压、缓解紧张情绪。长期使用香薰雾化仪可以让您得到更好的睡眠质量,更有效的集中精神和调理身心健康。

操作指南

- 1) 插上电源,或确保香薰雾化仪有充足的电量。
- 2) 第一次按开关:喷雾和氛围灯开始工作。
- 3) 第二次按开关:灯光关闭,喷雾照常运作。
- 4) 第三次按开关:停止工作。

功能指示

充电模式:红灯闪烁。

满电提示:灯光从红灯变成绿灯。

※ DOME 香薰雾化仪在充电时可同时运作,此时氛围灯为七彩变换。

※ 使用充电锂电池,充满电需要3.5个小时,可以持续使用大约5个小时。(*空气的湿度会影响香薰雾化仪的工作时长。)

※ 水箱无水时会自动关机。

注意

- 1) 请勿使用过载的电源插座、破损电源连接线或适配器,否则可能危及您的安全,为避免火灾隐患,请勿将产品放置在易燃物品附近;若有发现连接线损坏请及时更换。
- 2) 请勿擅自修改、拆卸、维修设备,以免设备损坏,如果设备发生异常,请及时前往任何一间HYSSES的店铺寻求意见。(*如果HYSSES鉴定产品损坏不在保固范围内,将会通知顾客,如果顾客确定要进行维修,将会被收取维修费用)。
- 3) 请定期对设备进行维护和清洁,确保本设备保持最佳工作状态,详情请参照清洁与保养。

使用方法

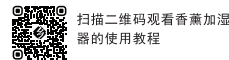
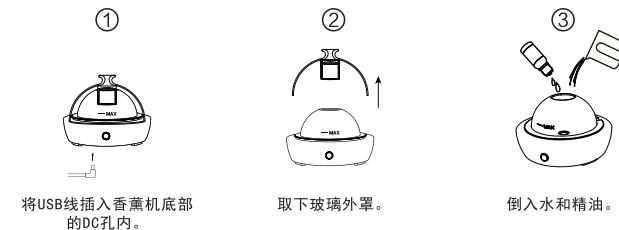

扫描二维码观看香薰加湿器的使用教程

清洁与保养

为了确保产品处于良好的状态,需对其进行定期清理,清理时请按照下述步骤操作。建议每周都按照以下步骤进行一次清理。

- 1) 将USB线从主机中拔出,托住底座并抓紧水箱玻璃向上抬起,打开玻璃外罩。(如下图)

* 打开外罩时,请务必将主机放置于稳定的水平位置,防止其倾倒。



- 2) 倒掉水箱内剩余水分。

- 3) 倒入20毫升的HYSSES Cleaning Solution, 用布蘸取并对机器进行擦拭。***注意:** 请勿用手直接接触或用力按压水箱底部中央的超声波雾化口。

- 4) 清洁完毕后,在水箱中倒入自来水运转30分钟,然后进行排水、擦拭,让其充分干燥。

- 5) 当外罩、水箱外侧沾有精油或污垢时,请用布蘸取HYSSES Cleaning Solution进行擦拭。

- 6) 喷雾口附近存有污垢时,使用HYSSES Cleaning Solution进行清洗。

- 7) 请定期查看机器底部进风口过滤器内是否有毛发、灰尘等物。如有这些附着物,请及时用棉签清除。

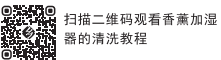

扫描二维码观看香薰加湿器的清洗教程

产品规格

外观尺寸: $\Phi 160 \times 123 \text{mm}$	产品材质: 玻璃+实木
产品重量: 约 760G	振动频率: 3.5MHz
使用电源: AC100-240V 50/60Hz / DC 5V/2A	最大容量: 200ml
电池容量: 4400mAh	适用面积: 50-400 SQF
噪音等级: $\leq 35 \text{db}$	功率: 10W

保修服务

要激活您的保修,请参阅提供的保修卡。如果您在店内购买了扩香器,我们的零售人员将协助您注册保修。对于在线订单,只需将以下详细信息以及保修卡的照片发送至online.orders@hyssees.com:

全名
电子邮件
联系电话
订单号

一旦我们收到您的信息,您的保修将成功激活。

Product Instruction

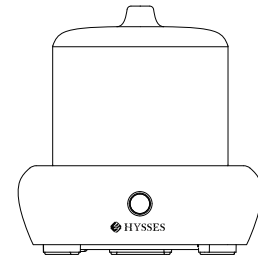

FOREST - Ultrasonic Water Mist

Indulge in a nature escapade in the comfort of your room simply with our Ultrasonic Water Mist Forest.

After-Sales Warranty & Checklist

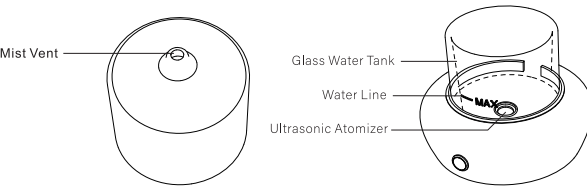
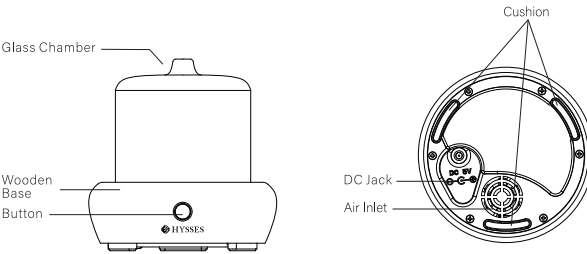

Checklist

- | | | |
|--|------------------------------------|--|
| <input type="checkbox"/> Glass Chamber | <input type="checkbox"/> Adapter | <input type="checkbox"/> Instruction Booklet |
| <input type="checkbox"/> Wooden Base | <input type="checkbox"/> USB Cable | <input type="checkbox"/> Warranty Card |

*Registration of warranty online www.barnandpotter.com/warranty within 7 days of purchase in order to activate warranty protection for this purchase.

Product Introduction

Forest Ultrasonic Water Mist uses ultrasonic frequencies to create vibrations on the water surface. The vibration creates negative ions and vaporises essential oil into micro droplets. The micro droplets are able to stay suspended in the air for longer periods of time, maximising the scenting effects and therapeutic benefits of essential oil. Negative ions clear the air of dust and allergens, normalises your breathing rate, decreases blood pressure, and relieves tension. Regular usage of the Ultrasonic Water Mist allows for better sleep, elevated mental performance, and health realignment.

Operating of Ultrasonic Water Mist:

- 1) Plug in, or ensure that the battery is fully charged.
- 2) Press the first time: Switch on the mist and light.
- 3) Press the second time: Switch off the lights.
- 4) Press the third time: Switch off the power.

Status Display

Charging mode: Red light will flash.

Fully charged mode: Red light will turn green.

- ✗ The Ultrasonic Water Mist can be used during charging, and the mood light will change colours.
- ✗ With rechargeable battery, it takes about 3.5 hours to fully charge, which can last for approximately 4 hours. (* Misting varies with the level of humidity in the environment.)
- ✗ It will switch off automatically when water runs out.

Notes

- 1) Do not use overloaded power outlet, damaged power cable or adapter, or it may pose threat to your safety. Avoid placing near areas that are fire hazard.
- 2) Do not attempt to revise, tear down or repair the product. Send to any of the HYSSES retail outlet to seek advice. (*Repair charges are applicable for machines not covered under warranty.)
- 3) Please maintain and clean the product regularly to ensure best working condition. Please refer to the Cleaning and Maintenance instruction.

Quick User Manual

①

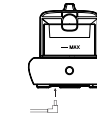

Insert the USB cable into the DC jack from bottom.

②



Remove the glass chamber.

③



Add water then essential oil.

④



Cover with the lid.

⑤



Plug into a power supply with the adapter. Once it's fully charged, you may use it without connecting to a power supply.

⑥



Press the button to on the device.



Scan the QR code to watch the tutorial on how to use a water mist.

Cleaning & Maintenance

To ensure product is in good condition, it is recommended to do a thorough cleaning and maintenance for the machine on weekly basis using the following steps:

- 1) Remove the USB cable from the diffuser, hold the base with one hand, hold the water tank cover with the other, lift it upwards, and open the water tank cover (as shown below).

* When opening the cover, please make sure to place the water mist on a flat surface to prevent it from falling.



- 2) Drain the remaining water.
- 3) Use 20 ml of HYSSES Cleaning Solution to rinse the glass chamber. ***Caution:** Don't directly touch or press the ultrasonic plate at the bottom center of the water tank.
- 4) After cleaning, add tap water and switch on the machine for 30 minutes. Drain, wipe and dry thoroughly.
- 5) To remove essential oil or dirt adhered to the outside of the unit cover or water tank, wet a cloth with HYSSES Cleaning Solution and wrung well.
- 6) If dirt accumulates near the nozzle, remove the unit cover and wash with HYSSES Cleaning Solution. Hold the tank cover and shake to remove the water inside, dry it before the next use.
- 7) Make sure that no hair or dust is on the air intake filter at the bottom. Use a cotton swab to remove any hair or dust. ***Caution:** The filter cover cannot be removed.



Scan the QR code to watch the tutorial on how to clean a water mist.

Specification

Product Size	Φ125x128mm
Weight	Approx. 685g
Power: Input/Output	AC100-240V 50/60Hz / DC 5V/1A
Tank Capacity	80ml
LED Light	Colorful light
Materials	Wood and glass
Noise Level (dB)	≤ 35 dB
Rate of Vibration	3.5MHz
Power	3.5W
Battery Capacity	3400mAh
Coverage	50-400 SQF

Warranty

To activate your warranty, please refer to the warranty card provided. If you purchased the diffuser in-store, our retail staff will assist with registering your warranty. For online orders, simply send the following details, along with a photo of your warranty card, to online.orders@hysses.com:

Full name
Email
Contact number
Order number

Once we receive your information, your warranty will be successfully activated.

产品使用说明书

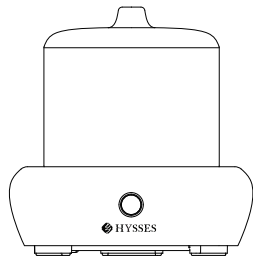

FOREST - 香薰雾化仪

FOREST 香薰雾化仪 带您探索大自然的奇妙之旅

售后保修与检查清单

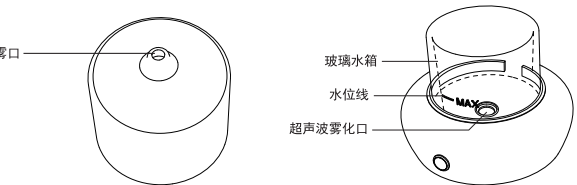
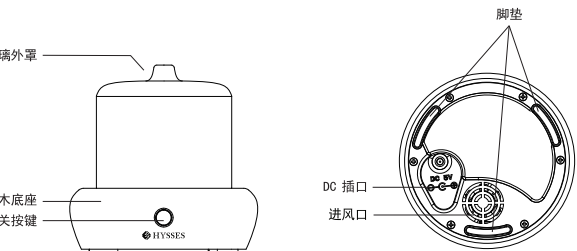

Checklist

- | | | |
|-------------------------------|----------------------------------|--------------------------------|
| <input type="checkbox"/> 玻璃外罩 | <input type="checkbox"/> 变压器 | <input type="checkbox"/> 使用说明书 |
| <input type="checkbox"/> 实木底座 | <input type="checkbox"/> USB 连接线 | <input type="checkbox"/> 保修卡 |

* 请参照附件中的保修卡，并在购买日起的7天内于www.barnandpotter.com/warranty上注册并填写保修单。

产品简介

FOREST香薰雾化仪运用了超声波技术,通过在水面振动的频率产生了负离子同时使精油雾化成为微米级的水粒子。这些水粒子能在空气中停留更长的时间,使精油的芳香与功效发挥到极致。负离子能清除空气中的尘埃和降低过敏的风险,调节您的呼吸频率,降低血压、缓解紧张情绪。长期使用香薰雾化仪可以让您得到更好的睡眠质量,更有效的集中精神和调理身心健康。

操作指南

- 1) 插上电源,或确保香薰雾化仪有充足的电量。
- 2) 第一次按开关:喷雾和氛围灯开始工作。
- 3) 第二次按开关:灯光关闭,喷雾照常运作。
- 4) 第三次按开关:停止工作。

功能指示

充电模式:红灯闪烁。

满电提示:灯光从红灯变成绿灯。

※ FOREST香薰雾化仪在充电时可同时运作,此时氛围灯为七彩变换。

※ 使用充电锂电池,充满电需要3.5个小时,可以持续使用大约4个小时。(*空气的湿度会影响香薰雾化仪的工作时长。)

※ 水箱无水时会自动关机。

注意

- 1) 请勿使用过载的电源插座、破损电源连接线或适配器,否则可能危及您的安全,为避免火灾隐患,请勿将产品放置在易燃物品附近;若有发现连接线损坏请及时更换。
- 2) 请勿擅自修改、拆卸、维修设备,以免设备损坏,如果设备发生异常,请及时前往任何一间HYSES的店铺寻求意见。(*如果HYSES鉴定产品损坏不在保固范围内,将会通知顾客,如果顾客确定要进行维修,将会被收取维修费用)。
- 3) 请定期对设备进行维护和清洁,确保本设备保持最佳工作状态,详情请参照清洁与保养。

使用方法

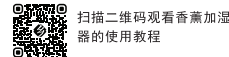
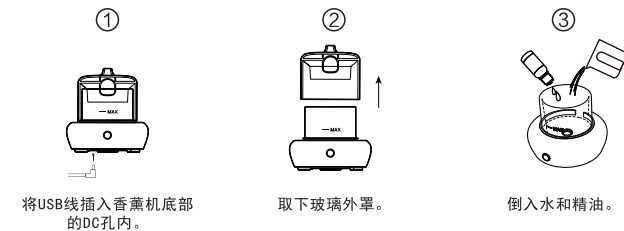

扫描二维码观看香薰加湿器的使用教程

清洁与保养

为了确保产品处于良好的状态,需对其进行定期清理,清理时请按照下述步骤操作。建议每周都按照以下步骤进行一次清理。

- 1) 将USB线从主机中拔出,托住底座并抓紧水箱玻璃向上抬起,打开玻璃外罩。(如下图)

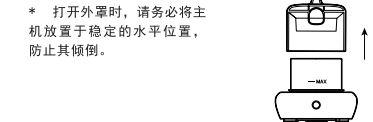

- 2) 倒掉水箱内剩余水分。

- 3) 倒入20毫升的HYSES Cleaning Solution, 用布蘸取并对机器进行擦拭。***注意:** 请勿用手直接接触或用力按压水箱底部中央的超声波雾化口。

- 4) 清洁完毕后,在水箱中倒入自来水运转30分钟,然后进行排水、擦拭,让其充分干燥。

- 5) 当外罩、水箱外侧沾有精油或污垢时,请用布蘸取HYSES Cleaning Solution进行擦拭。

- 6) 喷雾口附近存有污垢时,使用HYSES Cleaning Solution进行清洗。

- 7) 请定期查看机器底部进风口过滤器内是否有毛发、灰尘等物。如有这些附着物,请及时用棉签清除。

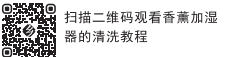

扫描二维码观看香薰加湿器的清洗教程

产品规格

外观尺寸:	Φ 125x128mm	产品材质:	玻璃+实木
产品重量:	约 685G	振动频率:	3.5MHz
使用电源:	DC 5V/1A	最大容量:	80ml
电池容量:	3400mAh	适用面积:	50-400 SQF
噪音等级:	≤35db	功率:	3.5W

保修服务

要激活您的保修,请参阅提供的保修卡。如果您在店内购买了扩香器,我们的零售人员将协助您注册保修。对于在线订单,只需将以下详细信息以及保修卡的照片发送至online.orders@hyses.com:

全名
电子邮件
联系电话
订单号

一旦我们收到您的信息,您的保修将成功激活。