

iiRcade Stand Assembly Manual

iiRCADE

www.iiRcade.com



WARNING



Product Safety Warnings

1. Heavy product. Please have a minimum of 2 adults when lifting the product.
2. Serious or fatal injuries can occur from the device tipping over. To help prevent the device from tipping over and ensure a safe gaming environment, please follow these instructions :
 - Use the wall mount kit that is included with the product to mount the product to the wall
 - Properly place the bartop on the stand and use the mount screws to secure the bartop to the stand
 - Make sure the device is level with the floor by adjusting the foot screws on the stand
3. Use the corner safety kit included with the product to cover the corners of the controller box to prevent injury.
4. Never allow children to climb or hang on the product.

Please note that these instructions may only reduce, but not eliminate, the risk of tip-over or injury. Please always use safety cautions and have adult supervision when gaming on iiRcade.



Product Assembly Warnings

1. Adult assembly required.
2. Prior to assembly, please remove the cabinet parts from the shipping box and inspect them for any visible signs of damage or missing parts.
3. For proper assembly, please follow the instructions in order as stated in this document.
4. Please do not over tighten the screws or cam nuts.
5. Please assemble the product on a proper floor covering to prevent the product from damaging and the floor from being scratched during assembly.

iiRcade assumes no liability for improper installation or excessive loads placed on screws or cam nuts. For a step-by-step instructional video on how to assemble iiRcade or contacting customer service for any questions you may have on assembly of the product or any issues with parts, please visit <https://iircade.com>.

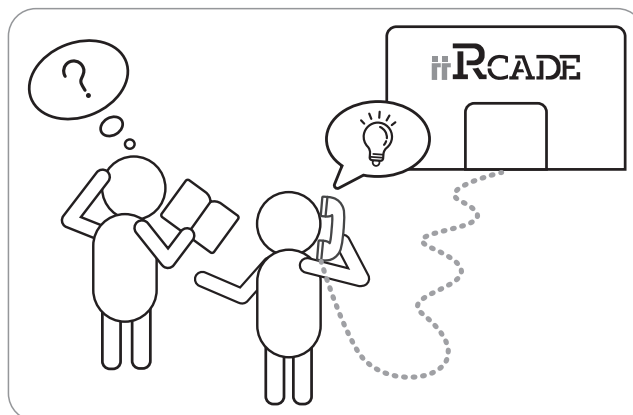
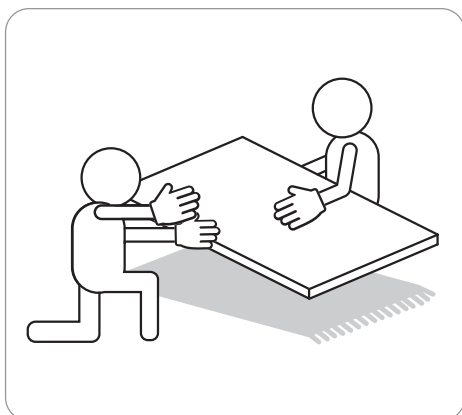

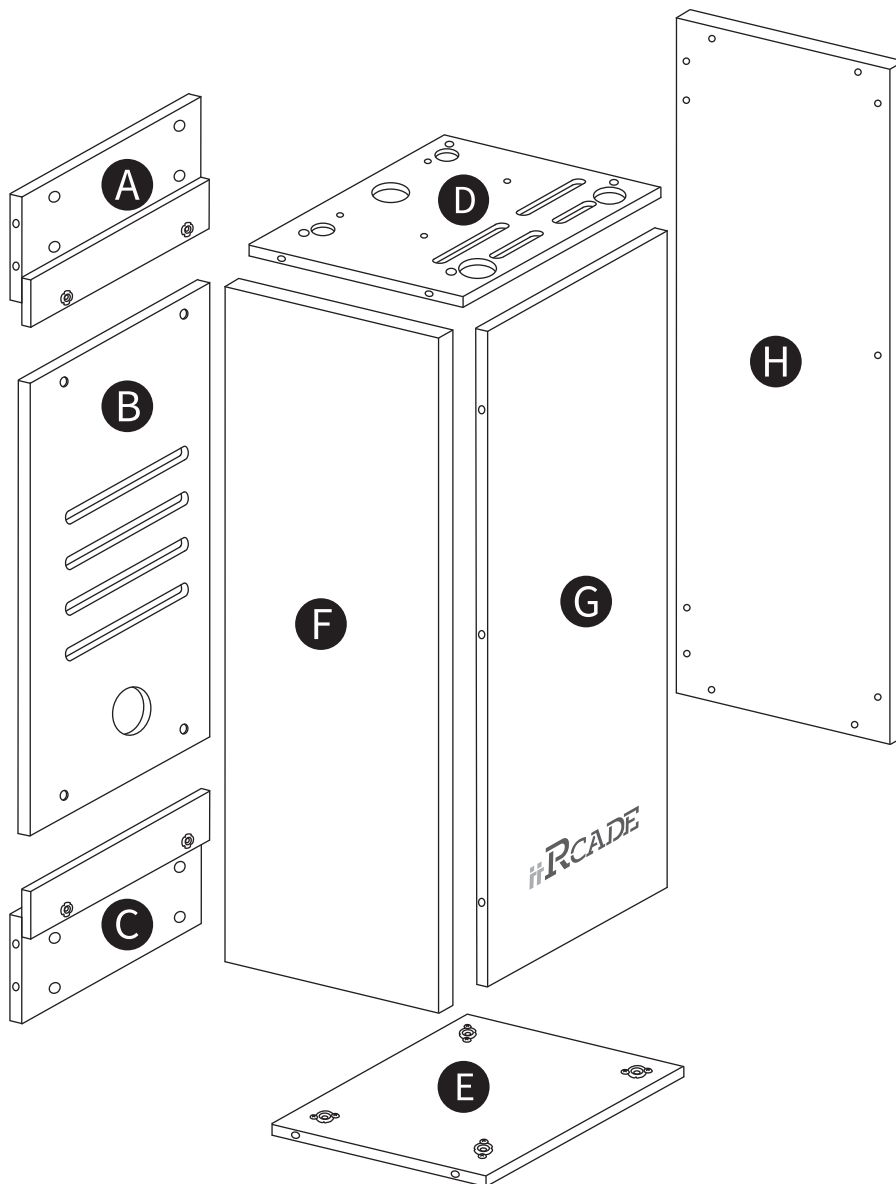

①



22 PCS

②



22 PCS

③

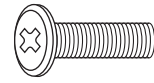

4 PCS

④

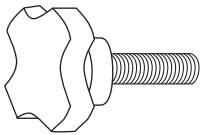

4 PCS

⑤

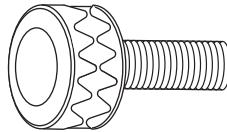

4 PCS

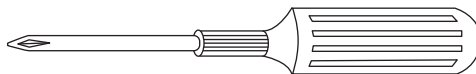

A

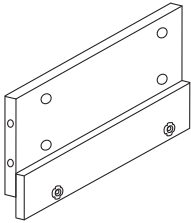

B

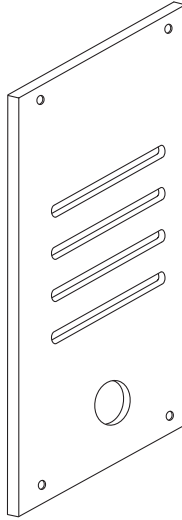

C

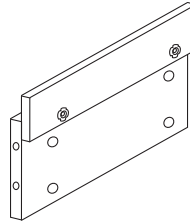

D

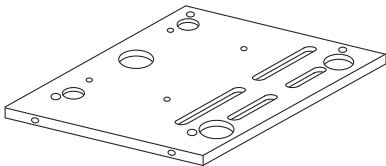

E

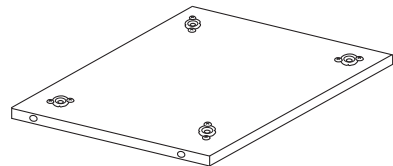

F

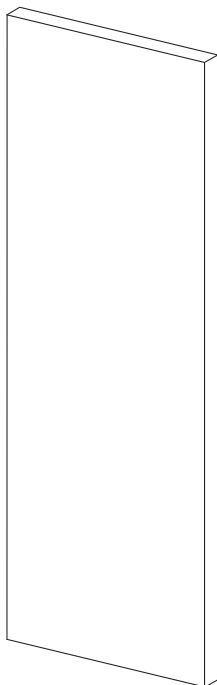

G

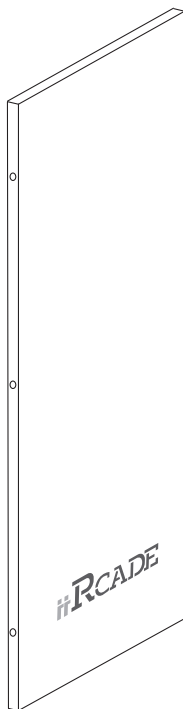

H

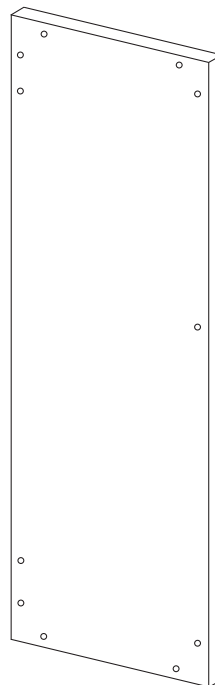

1

②  x 22

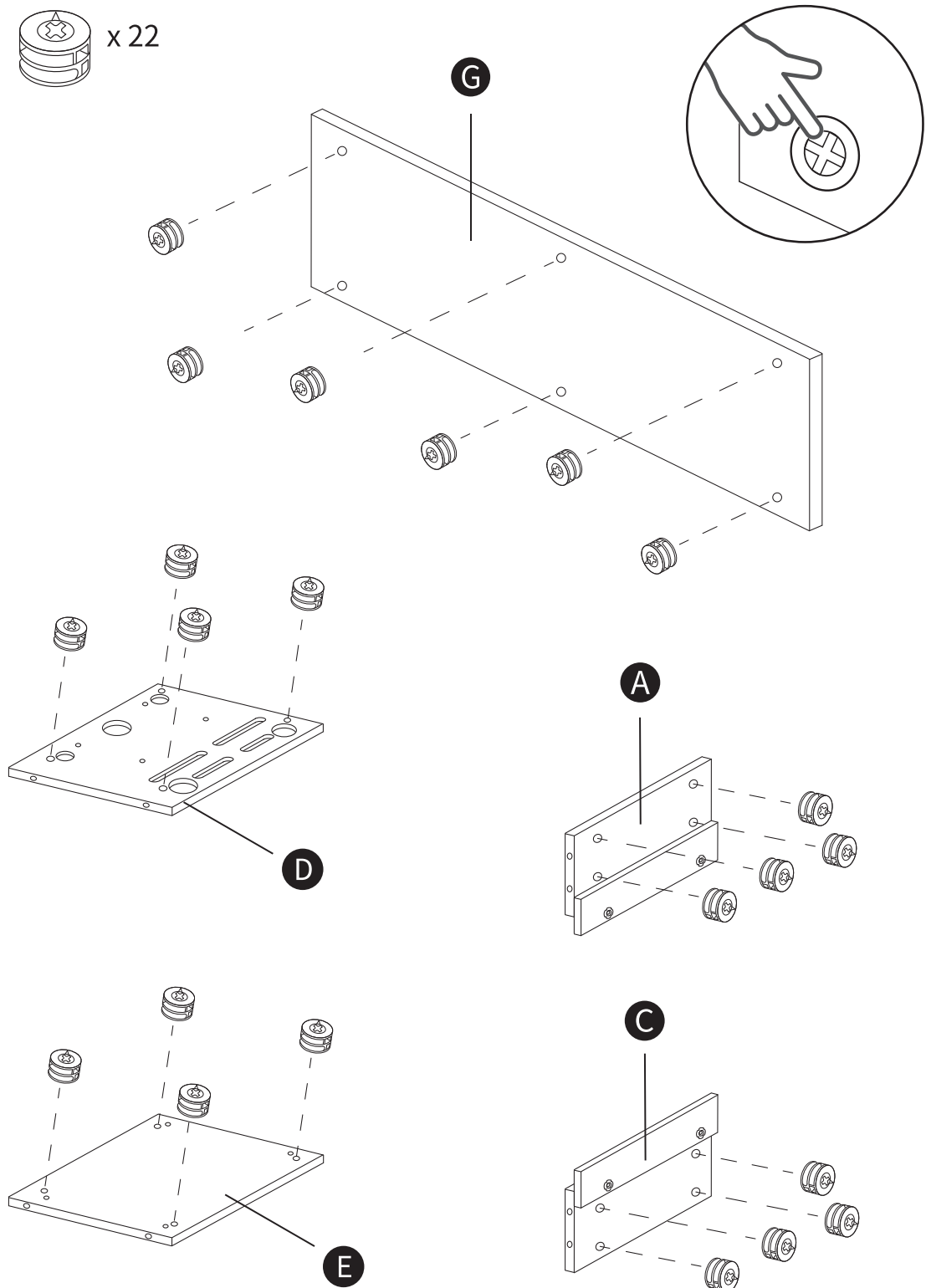

2

①  x 22

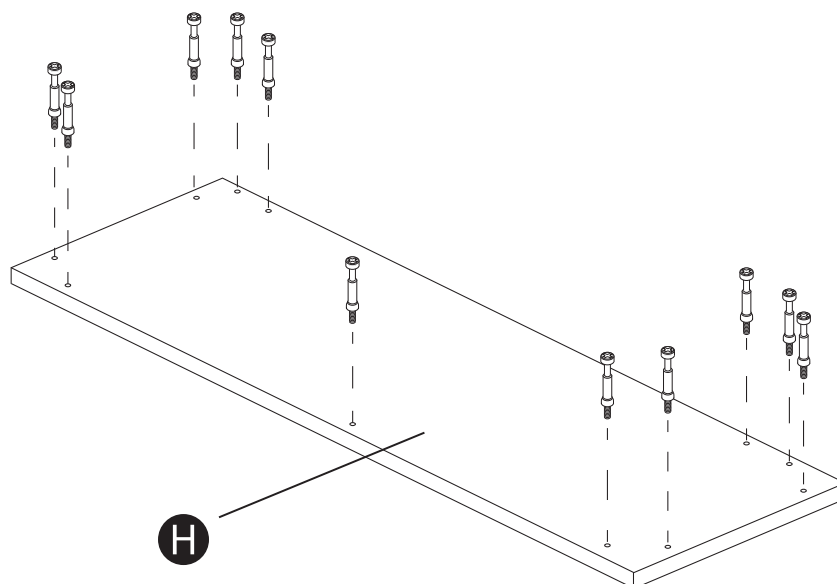
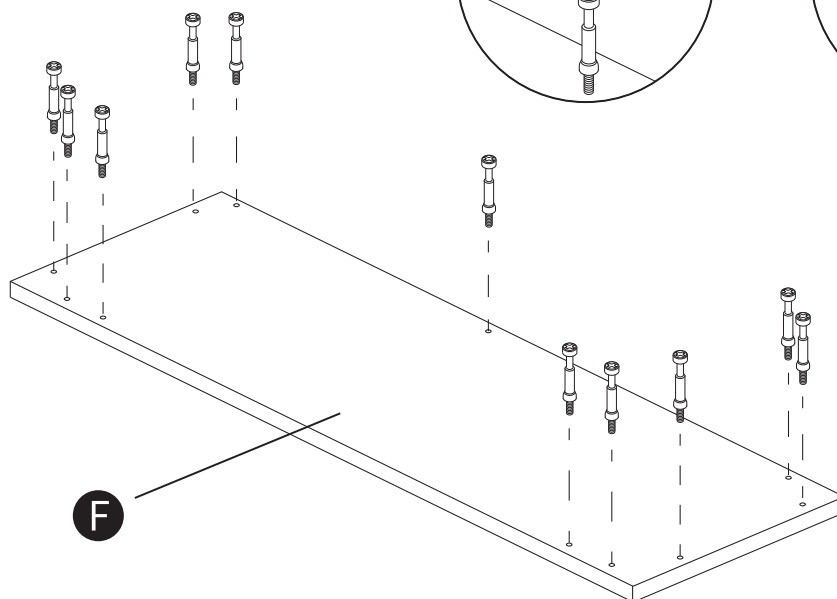
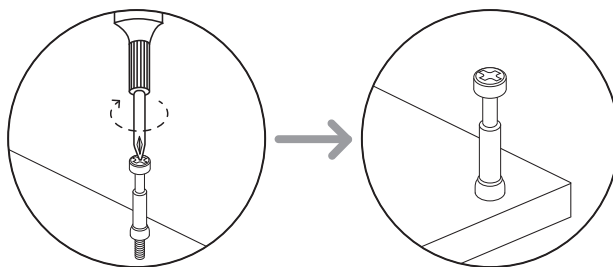

3

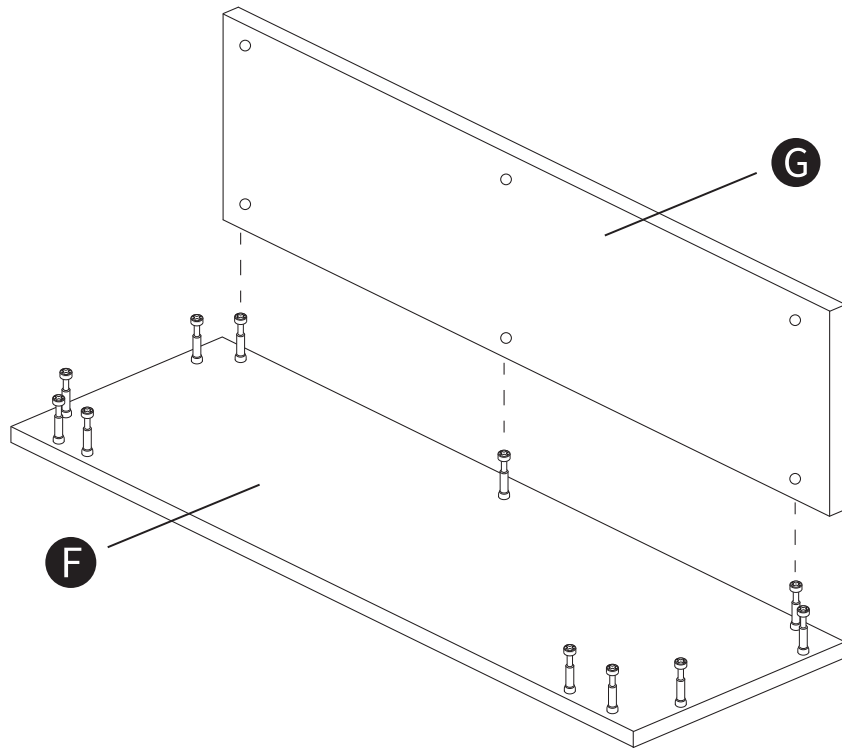

4

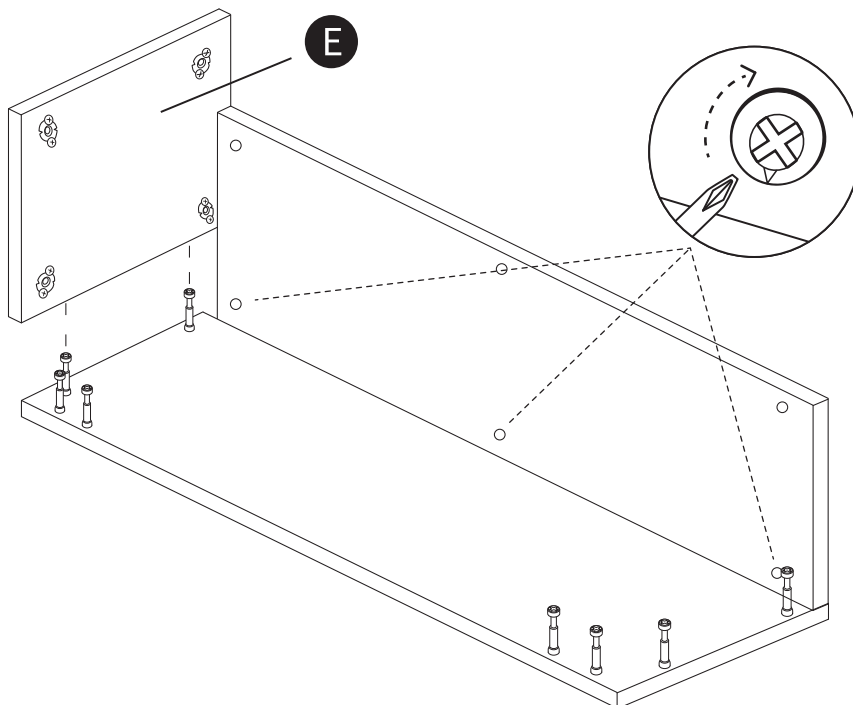

5

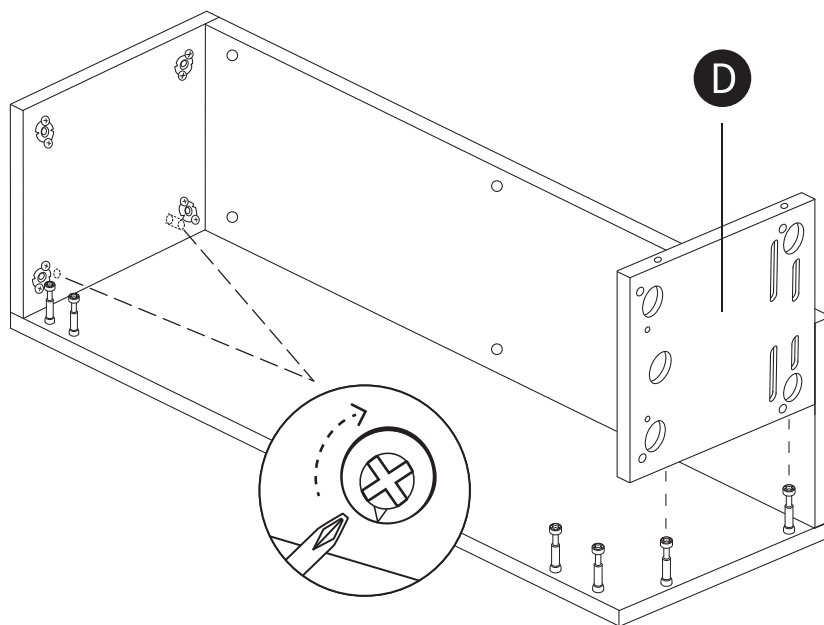

6

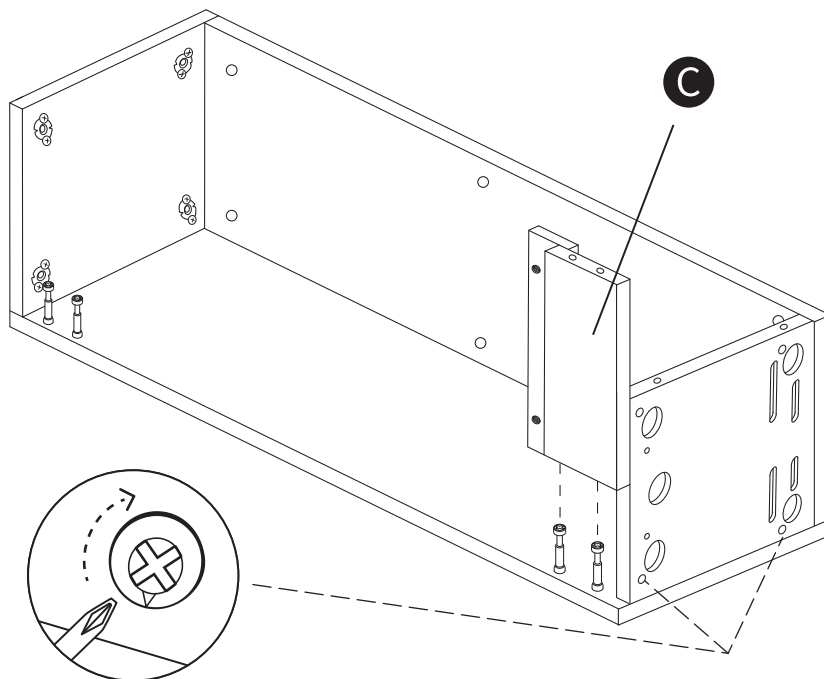

7

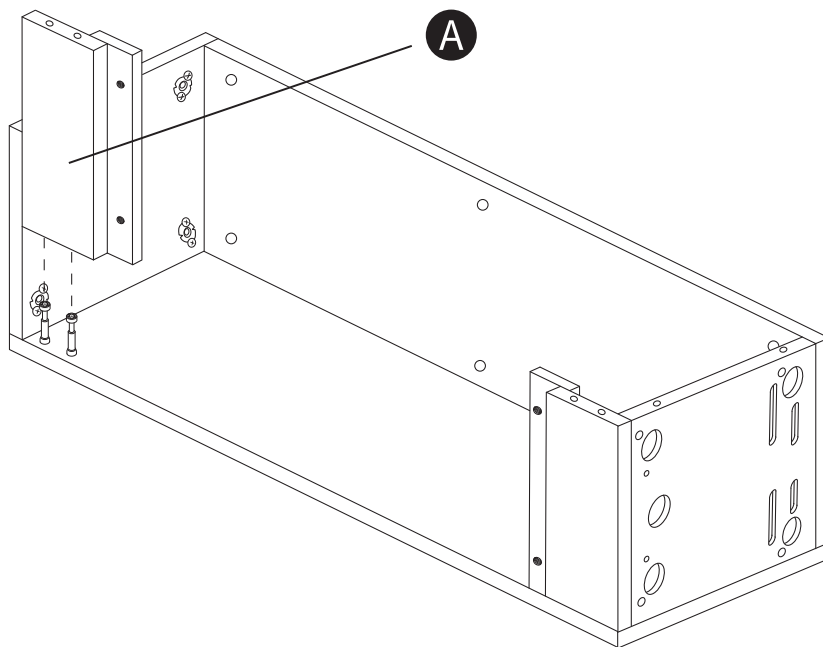

8

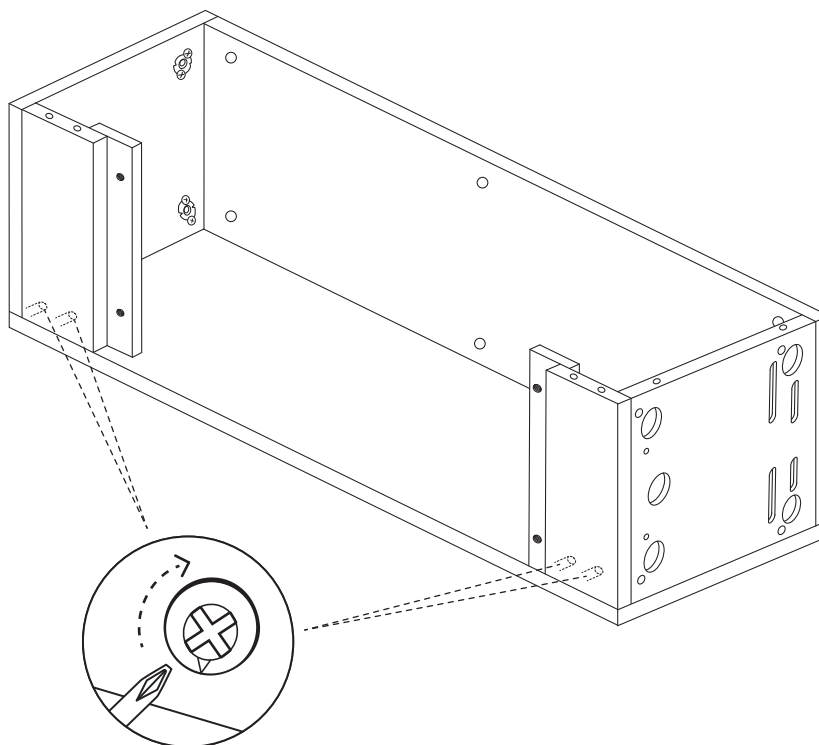

9

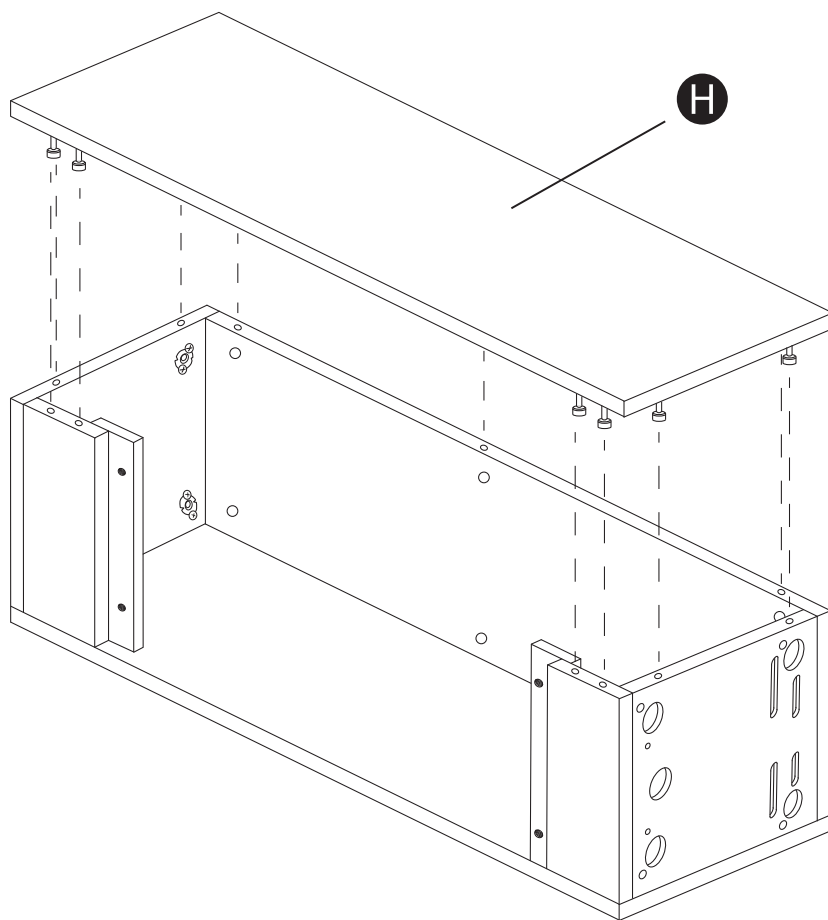

10

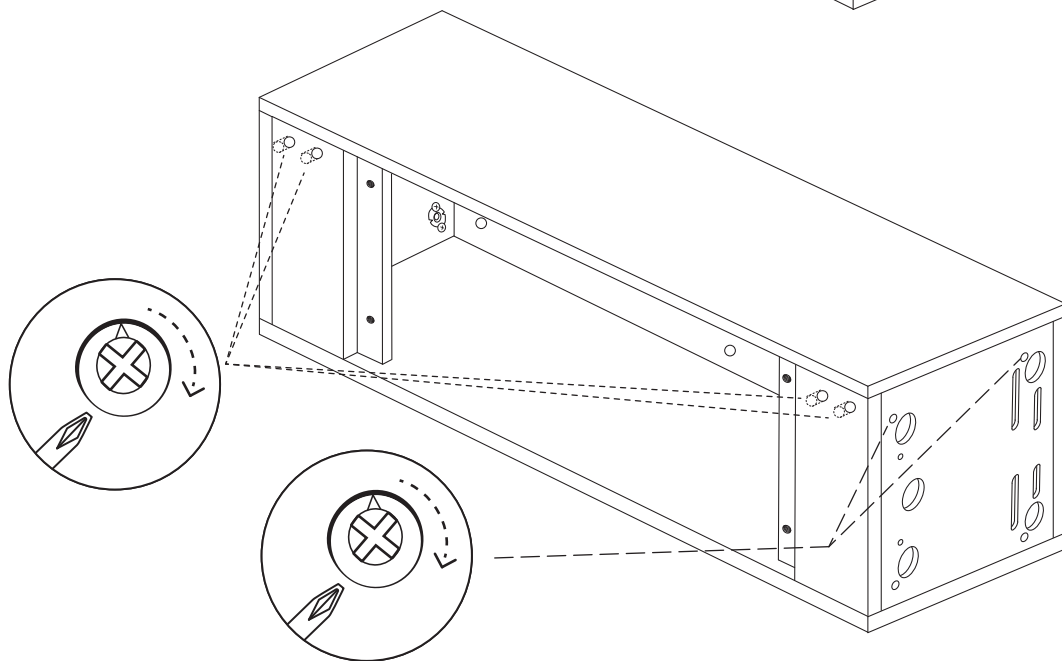

11

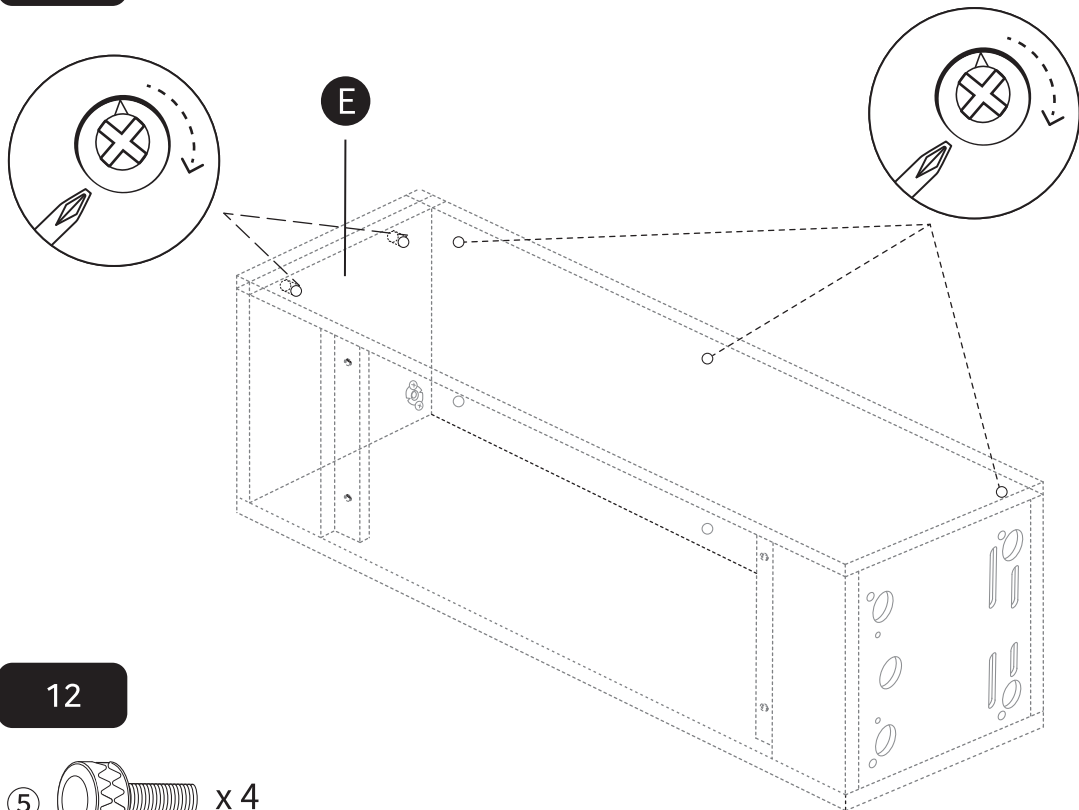

12

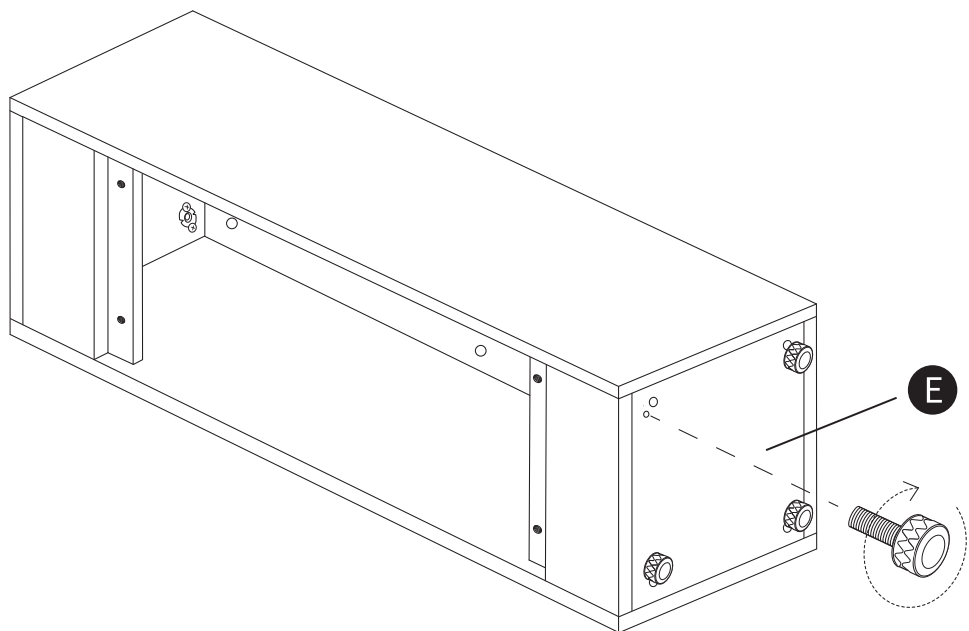
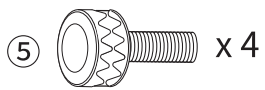

13

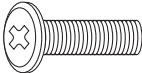
③  x 4

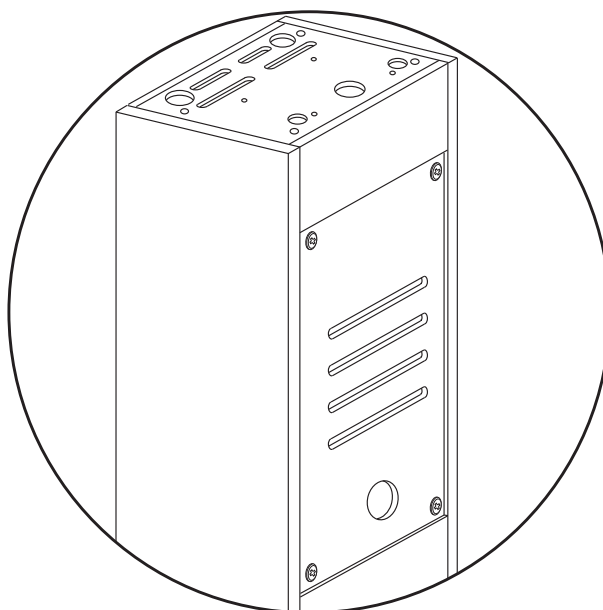
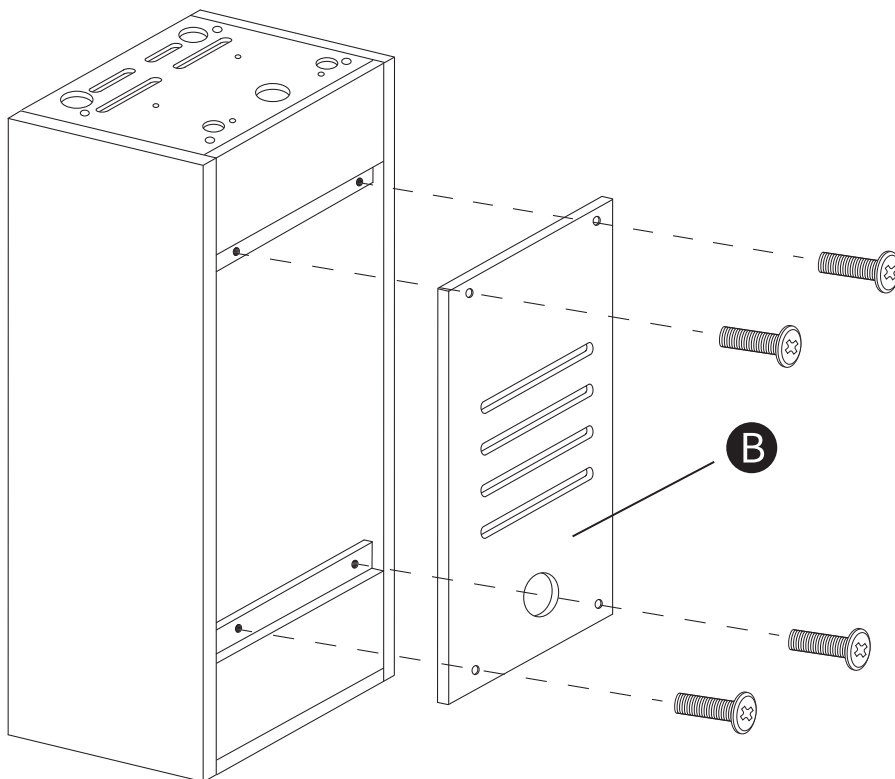

14

