

## Installation and user instructions

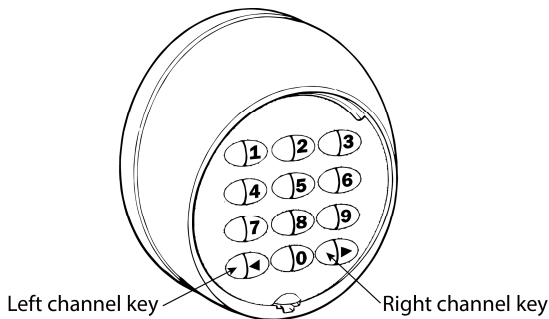

A	TECHNICAL SPECIFICATIONS	
Power supply.	3VDC (1 x CR2450 or CR2430 battery)	
Battery life.	+/- 120 000 operations.	
Power saving for enhanced battery life.	Built in daylight sensor. LED lighting will only be active in the dark.	
Battery low indication.	10 long beeps after any valid user entry code activation.	
Channels.	2	
Frequency.	433.92MHz.	
Transmission format options.	ET BLU MIX © and ET BLUE rolling code.	
Operating temperature.	-10°C to 50°C.	
Number of digits per code.	0 – 8 digits.	
Maximum number of user codes.	100	
Estimated transmission range. Line of sight in a radio clutter free environment.	+/- 200m outdoors and +/- 35m indoors.	
Ingress protection.	IP54	
Dimensions.	85 x 75 x 37mm	
Weight.	265g	
Factory default.	Programming code – 1234, User 001 code – 3333, Transmission format – ET BLU MIX © both channels.	

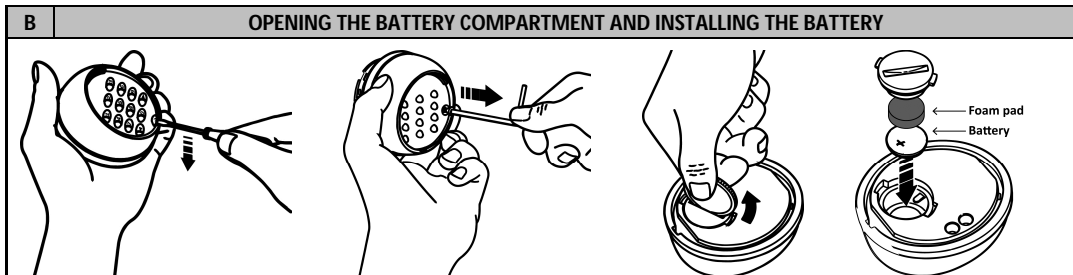

C	RECOMMENDED INSTALLATION PROCEDURE
1.	Factory default your new E-Pad O <sub>2</sub> wireless keypad. (Page 2, table D)
2.	If necessary change the transmission format of the channel/s to match the receiver/s. (Page 2, table E)
3.	Pair your new E-Pad O <sub>2</sub> wireless keypad with the receiver/s that it is intended to activate. (Page 3, table F)
4.	Select a few mounting position options for the keypad and test to ensure each transmission makes it through to the receiver/s every time. (Page 4, table L)
5.	When satisfied that you have found the most suitable mounting position that does not impact negatively on the radio transmission functionality of the system, mount the keypad securely. (Page 4, table J)
6.	With the keypad mounted and paired to the receiver/s you can now configure the user access to the system by adding new user codes. (Page 3, table G)
7.	Secure your installation by changing the programming code to a new unique code for that site. (Page 4, table K)

D	FACTORY DEFAULTING AND UNPAIRING THE E-PAD O <sub>2</sub> FROM THE RECEIVER/S
1.	Power down by removing the battery. (Page 1, table B)
2.	Hold both the < and > channel keys in.
3.	While holding in the < and > channel keys, return power by inserting the battery. <b>(Do not release the buttons until after point c below)</b> <ol style="list-style-type: none"> <li>LED and buzzer begins flashing and beeping intermittently to warn the factory default is about to occur. Releasing the buttons or powering down at this point aborts the process.</li> <li>LED stops flashing and buzzer silences while the factory default occurs.</li> <li>LED and buzzer return on permanently to indicate the factory default and unpairing is complete.</li> </ol>
4.	Release the < and > keys.

**NB! If at any point you hear 2 x low pitched beep tones followed by 1 x high pitched tone, then there has been an input error and the last input was not accepted. The system has automatically exited programming and you must start the routine again. Please note the exceptions to this rule @ point 3 in tables G and H.**

E	CHANGING THE TRANSMISSION FORMAT OF A CHANNEL BETWEEN ET BLUE OR ET BLU MIX © ROLLING CODE (Factory default – Both channels ET BLU MIX ©)			
ET BLUE receivers (plain orange antenna) will only work using ET BLUE format. The keypad channel transmission format will need to be changed before trying to pair that channel with the receiver.				
	Requirement.	Action.	Buzzer response.	LED response.
1	Enter programming.	Press and hold <b>0</b> for 3 seconds.	X 1	Flashing.
		Type in programming code followed by <.	X 2 High pitches.	Flashing.
2	Select changing the transmission format function.	Type in 4 followed by <.	X 1	On.
3	Select channel to be changed.	To make < channel ET BLUE type <b>1</b> < or, To make > channel ET BLUE type <b>2</b> < or, To make both channels ET BLUE type <b>3</b> < or, To make the < channel ET BLU MIX © type <b>4</b> < or, To make the > channel ET BLU MIX © type <b>5</b> < or, To make both channels ET BLU MIX © type <b>6</b> <.	X 1	X 1
4	The system automatically exits programming at this point.		X 1 High pitch.	Off.

<b>PAIRING THE E-PAD O<sub>2</sub> WITH ANY ET BLUE OR ET BLU MIX<sup>®</sup> COMPATIBLE RECEIVER</b> NB! This is best achieved with the keypad an arm's length away from the receiver.	
<b>F</b>	
1.	Type in any valid user code assigned to the keypad channel that must activate the receiver. (User 001 default - 3333)
2.	Hold either the < or > channel key that must activate the receiver.
3.	While holding that channel key, put the receiver into program mode as per normal for that receiver.
4.	When the receiver confirms the keypad channel code has been programmed into the receiver memory, release the keypad channel key.

<b>ADDING USER CODES</b>				
	Requirement.	Action.	Buzzer response.	LED response.
1	Enter programming.	Press and hold <b>0</b> for 3 seconds.	X 1	Flashing.
		Type in programming code followed by <.	X 2 High pitches.	Flashing.
2	Select adding user codes function.	Type in <b>1</b> followed by <.	X 1	On.
3	Select user address.	Type in <b>3 digit user address</b> followed by <.	X 1 = Successful.	X 1 Flash.
		<b>NB! On first time setup, user 001 will need to be deleted first before changing its code.</b>	X 2 = Unsuccessful. Address already in use. Delete the user first or try another address.	X 2 Flashes
4	Add user code.	Type in new user code followed by <. <i>(Code can be any length from 0 to 8 digits long)</i>	X 1	X 1
5	Select channel to be activated.	For < channel type in <b>1</b> followed by < or, For > channel type in <b>2</b> followed by < or, For both channels type in <b>3</b> followed by <	X 1	X 1
6	Repeat from step 3 to add more user codes.			
7	Exit programming.	Press and release > or wait 20 seconds.	X 1 High pitch.	Off.

<b>DELETING USER CODES (Individually)</b>				
	Requirement.	Action.	Buzzer response.	LED response.
1	Enter programming.	Press and hold <b>0</b> for 3 seconds.	X 1	Flashing.
		Type in programming code followed by <.	X 2 High pitches.	Flashing.
2	Select deleting a user code function.	Type in <b>2</b> followed by <.	X 1	On.
3	Select user address.	Type in <b>3 digit user address</b> followed by <.	X 1 = Successful.	X 1 Flash.
			X 2 = Unsuccessful. Invalid address. Try another address.	X 2 Flashes.
4	Delete user address.	Type in <b>0</b> followed by <.	X 1	X 1
5	Select channel to be deactivated.	For < channel type in <b>1</b> followed by < or, For > channel type in <b>2</b> followed by < or, For both channels type in <b>3</b> followed by <	X 1	X 1
6	Repeat from step 3 to delete more user codes.			
7	Exit programming.	Press and release > or wait 20 seconds.	X 1 High pitch.	Off.

<b>I DELETING ALL USER CODES (Programming code remains unchanged)</b>				
	Requirement.	Action.	Buzzer response.	LED response.
1	Enter programming.	Press and hold <b>0</b> for 3 seconds.	X 1	Flashing.
		Type in programming code followed by <b>&lt;</b> .	X 2 High pitches.	Flashing.
2	Select deleting all user codes function.	Type in 3 followed by <b>&lt;</b> .	X 1	On.
3	Select all user addresses option.	Type in 999 followed by <b>&lt;</b> .	X 1 = Successful.	X 1 Flash.
4	The system automatically exits programming at this point.		X 1 High pitch.	Off.

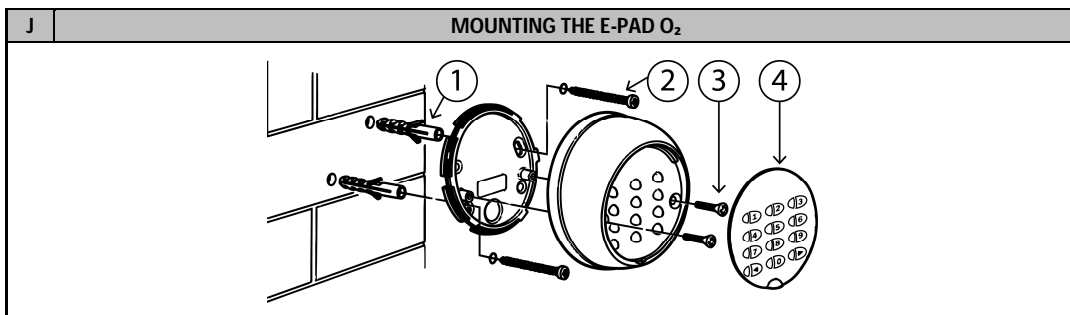

<b>K CHANGING THE PROGRAMMING CODE</b>				
	Requirement.	Action.	Buzzer response.	LED response.
1	Enter programming.	Press and hold <b>0</b> for 3 seconds.	X 1	Flashing.
		Type in programming code followed by <b>&lt;</b> .	X 2 High pitches.	Flashing.
2	Select change programming code function.	Type in <b>0</b> followed by <b>&lt;</b> .	X 1	On.
3	Enter new programming code.	Type in new code followed by <b>&lt;</b> . <i>(Code can be any length from 4 to 8 digits long)</i>	X 1 = Successful.	X 1 Flash.
4	The system automatically exits programming at this point.		X 1 High pitch	Off

<b>L HOW TO USE A USER CODE TO ACTIVATE A RECEIVER</b>			
	Requirement.	Action.	Response.
1	Activate receiver.	Type in a valid user code followed by either the <b>&lt;</b> or <b>&gt;</b> channel key that has been assigned to the receiver that you want to activate. (User 001 default – 3333)	Buzzer beeps rapidly so long as channel button is being pressed.

<b>M MULTIPLE INVALID USER CODE HACKING LOCKOUT</b>	
<p>As a security measure, in the case of someone trying to stumble across a valid user entry code by typing in multiple random codes, the E-PAD O<sub>2</sub> will enter a mandatory 5 minute lock-out after the fifth consecutive incorrect code entry. After the 5 minute lock-out has expired, you will be able to use the keypad again.</p> <p>In the case of 5 consecutive lock-outs occurring, the E-Pad O<sub>2</sub> has a further security measure whereby it will lock-out permanently until it is powered down and up again. During lockout any key press results in 5 rapid beep tones.</p>	