



Contact

80-six.com
virtualproductionstudios.com
0333 5777 899
info@80-six.com

Virtual Production Studios by 80six

Unit 1
Slough Interchange
Whittenham Close
Slough SL2 5EP



We are...

Home to new
technologies
and ideas.

We are...

Experts in system
integration and
challenging the
status quo.

We are...

Commended for
the innovative
integration of
virtual production
technology

100% Shutterstock
Winner: Best use of Virtual
Production at Ideas Awards

APA

LED Virtual Production is an exciting new technique - it's not the technology that's new, but the scale of experimentation. Since opening our studios in March 2021, at a temporary location, 80six has supported the likes of DNEG, Foundry, Lexhag VFX, Shutterstock, RSA Films to explore the real-time technologies & techniques for in-camera VFX (ICVFX) and XR (extended reality).

In May 2022, we re-opened our studio at a permanent location with double the footprint, now accommodating large-scale builds up to 8m.

Located next to the studio is 80six's tech warehouse, with one of the UK's most extensive inventories of award-winning ROE Visual products. This puts us in a fortunate position to be able to experiment against the norm by designing custom build LED Volumes that trial a large variety of stock or to respond immediately to last-minute production changes without the need to outsource inventory.

Dan Hamill
Co-Founder & Commercial
Director at 80six

Our Technology

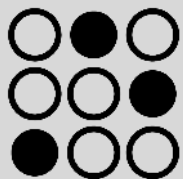

LED Displays



LED Processing

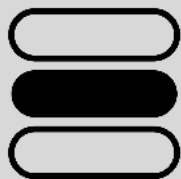

Media Servers



Cameras

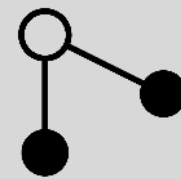

Camera Tracking

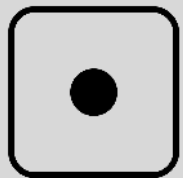

Video Monitors



Portable
Production Units



Video Switching
& Distribution

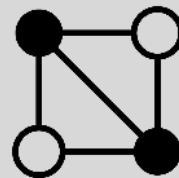

Rigging



Video Projectors

Technology Partners



01

On Site Virtual Production Studios

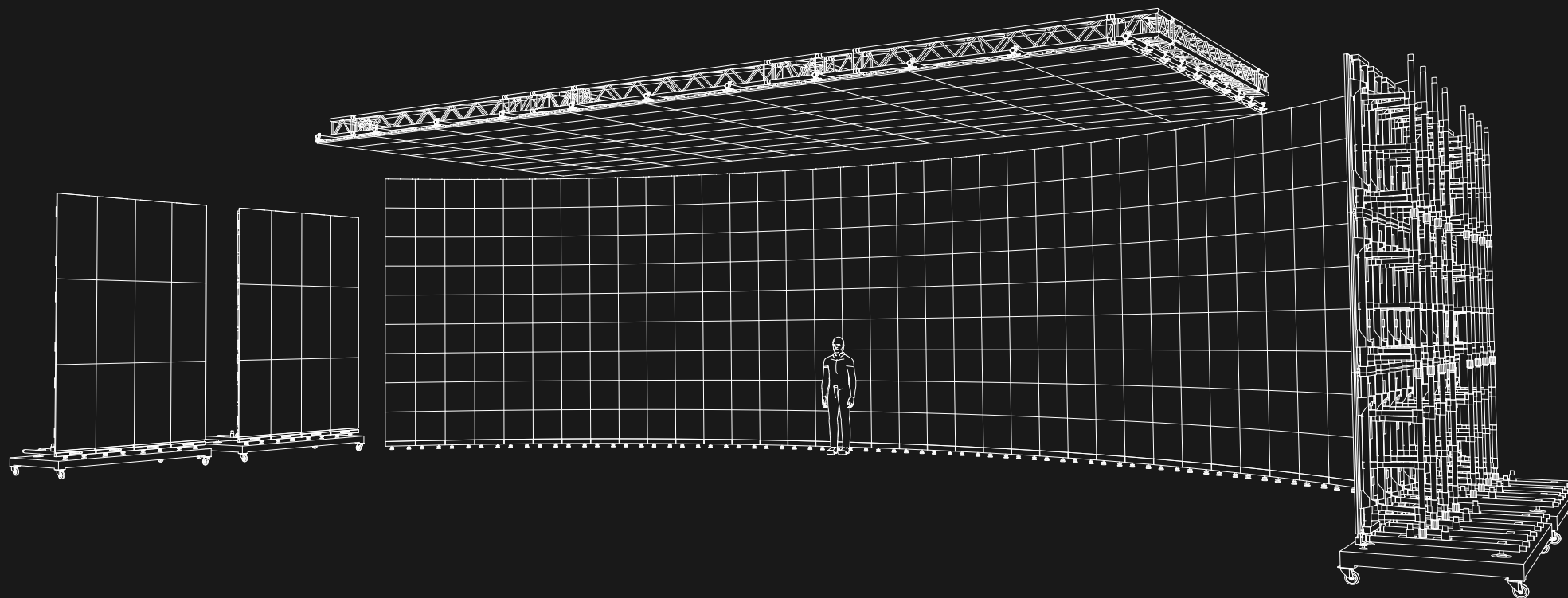

VPS: The Virtual Production Consulting Arm of 80six

Versatile
Bespoke
Scalable
Cost-Effective
Virtual Production Solutions

An 11,743 sq ft. purpose-built virtual production & mixed reality studio with bespoke LED stages and the latest real-time technologies (camera tracking, game engines, media servers) for delivering in-camera VFX (ICVFX) or xR (extended reality).





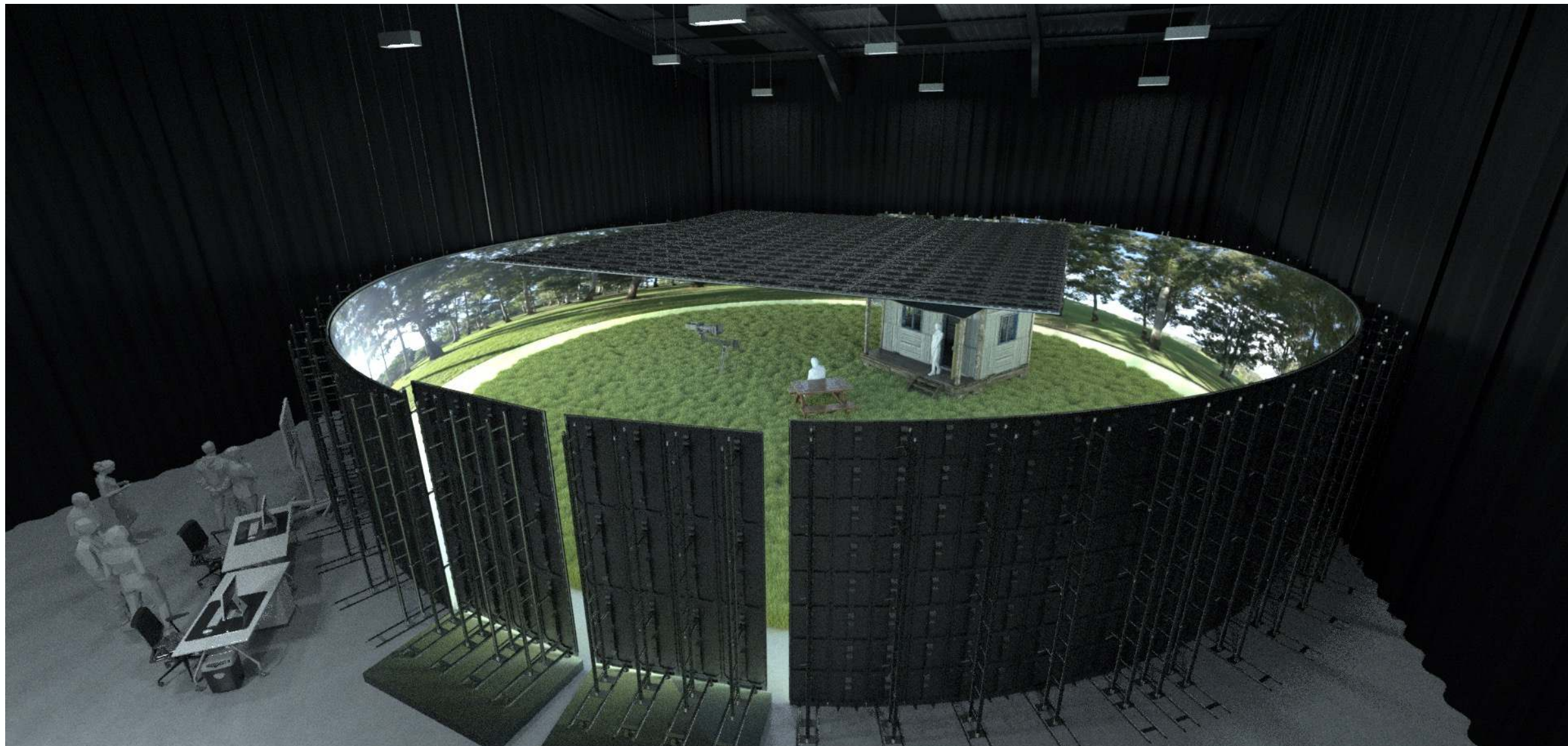

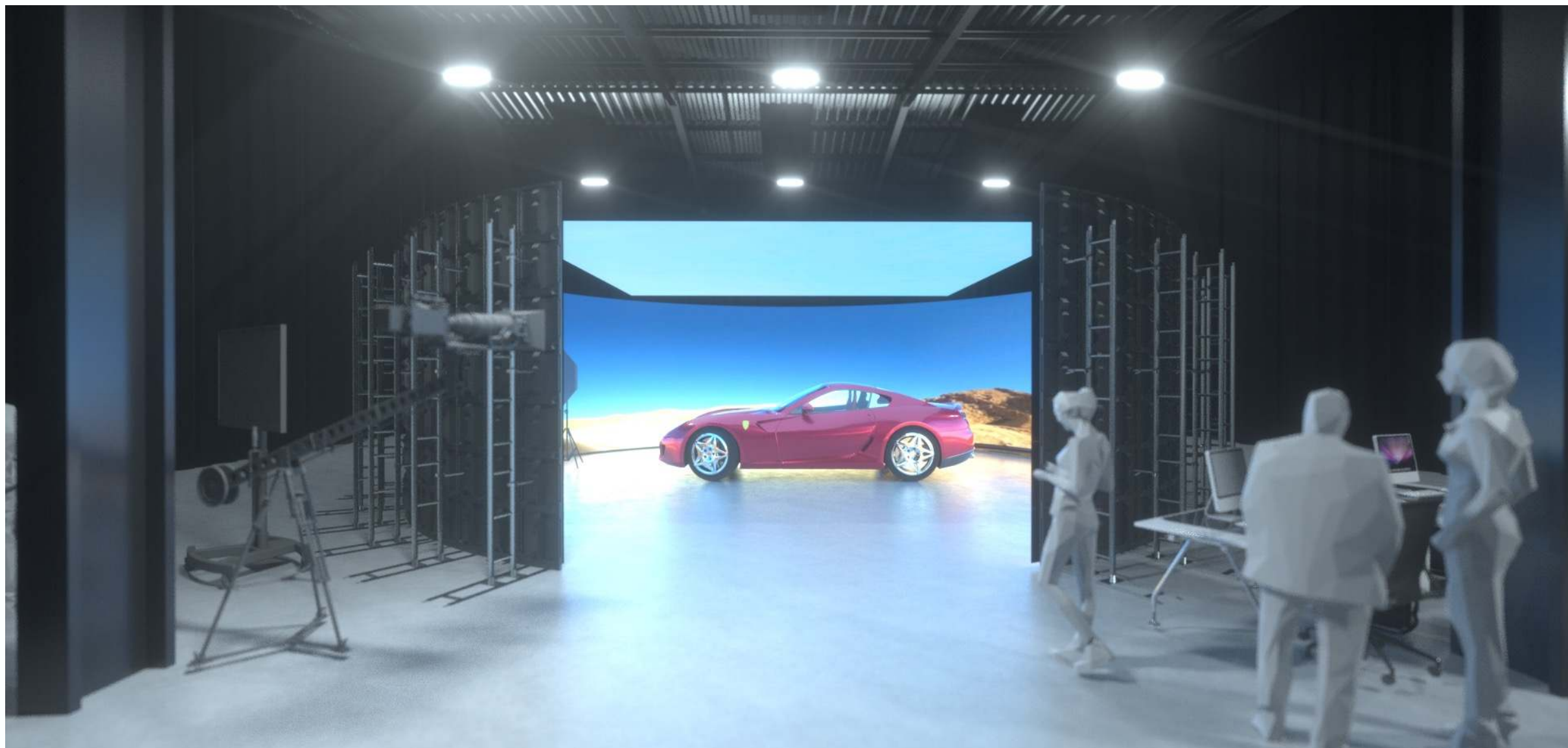

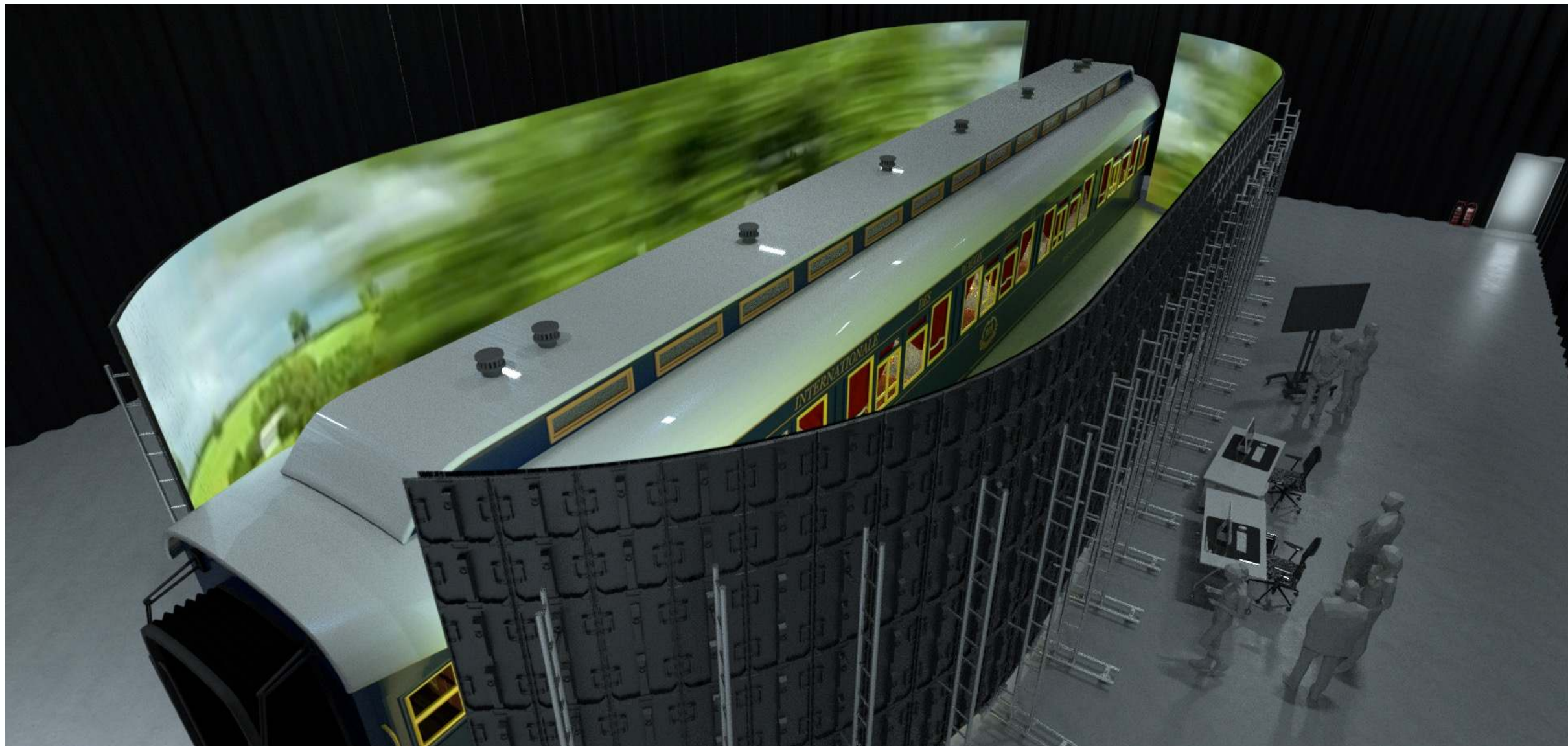

FACILITIES

Location: on the M4 corridor in Slough, 5-minutes walk from Slough train station, located in a secure gated business park (with overnight keycode access).

Size: 11,743 sq ft

Studio: 10,018 sq ft

Production Space: 1,725 sq ft

Yard Space: 6100 sq ft

Studio Height: 9.8m (lowest point) – 11.34m (highest point)

Security: Monitored CCTV and alarm system

Power: 1 x 125a 3ph / 2 x 63a 3 ph

Floor: Resin

Drapes: Perimeter drapes and drape rails included

Access: 3.8 x 6m drive in vehicle access; key fob access into the studio.

Rigging: 6 tonne roof capacity (spread over 2 RSJ beams)

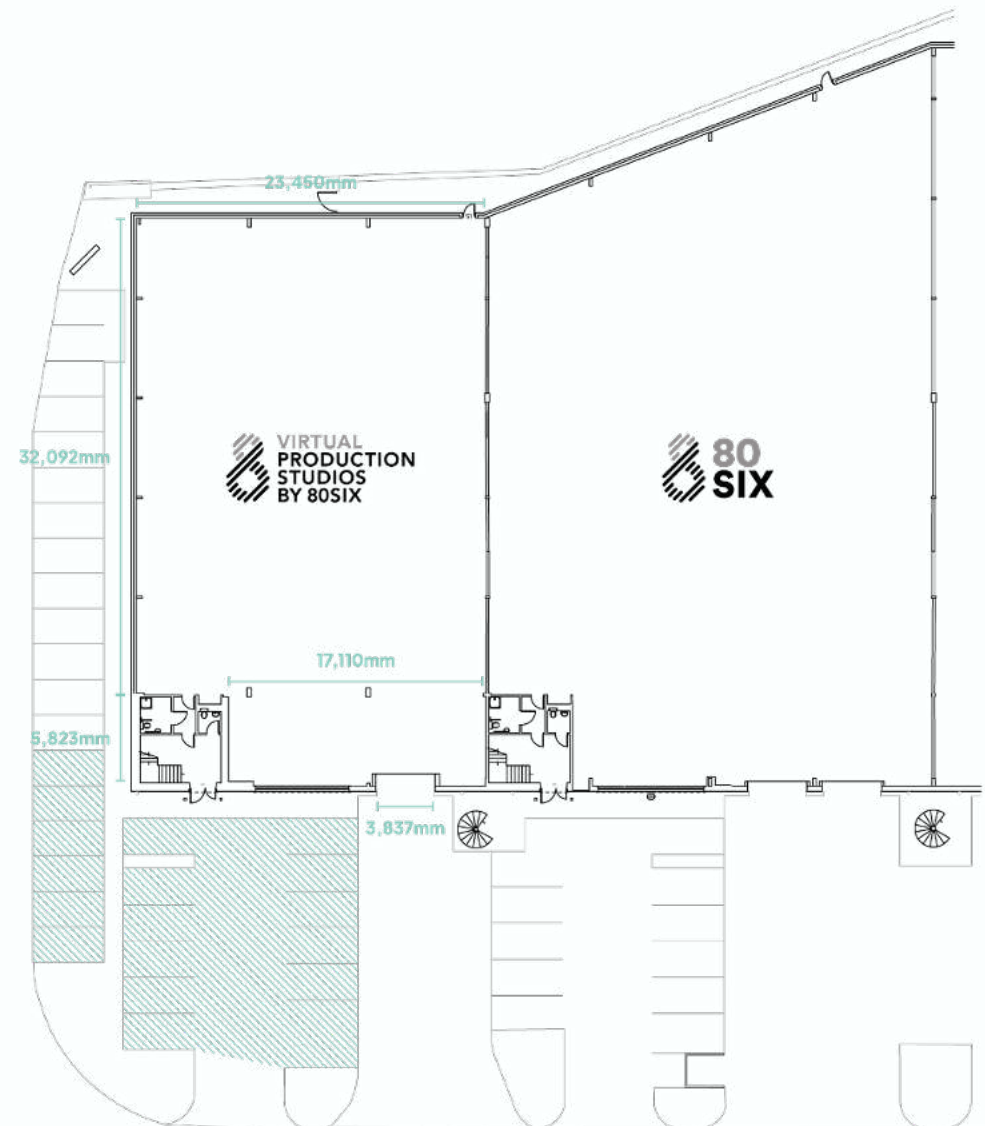

ADDITIONAL FACILITIES

Production Office: Open plan production space on the 1st floor with kitchenette & coffee and tea making facilities

Parking: up to 19 vehicles, including 2 truck spaces; Additional over spill parking for up to 18 cars; Additional truck space for 3 artics.

Internet: Dedicated High-speed (1GB) internet access and separate guest wi-fi (150MB up / 150MB down)

Toilets & Shower: Dedicated male and female toilets on both floors with one shower.

Local Amenities: There are several hotels (including the brand new Moxy and Residence Inn), shops & restaurants just a few minutes away.

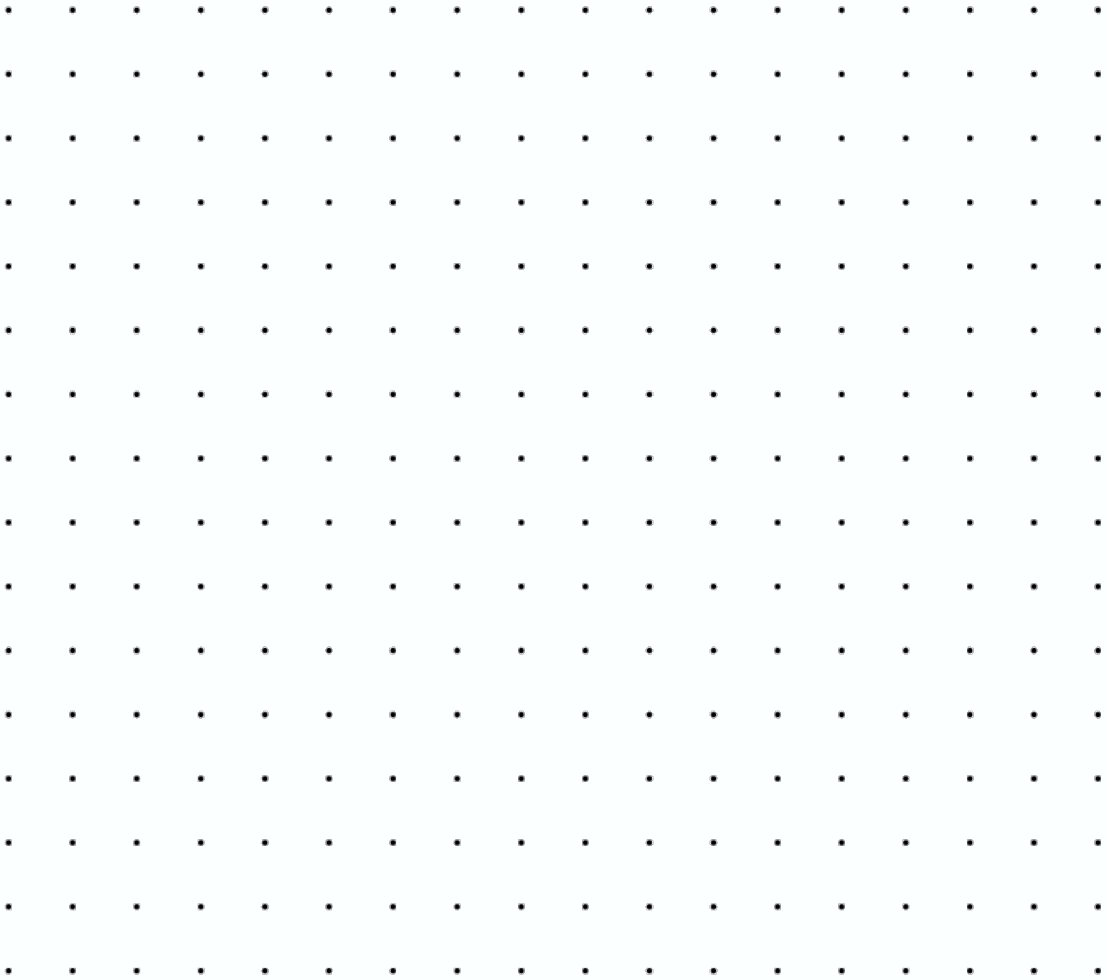

Technical and Creative Services

- Adaptable bespoke LED Volumes
- Disguise media server integration
- Unreal & Notch render engines
- Realtime re-active environments
- Realtime set extension
- Pre-visualization
- Video Animation & Editing
- Live camera tracking
- Motion control & robotics
- Multi camera video production
- Video distributing and switching
- Audio & Lighting integration



Flexible Virtual Production Solutions

Pricing provided on request.

01: On Site VPS

Technology / Service

What you get with 80six

Studio Facilities

- Rental of 11,743 sq ft studio space with 4-ton available roof loading capacity and screen room upstairs
- Production Office
- Socially distanced work zones
- Large loading doors
- Power 1 x 125/3ph, 2 x 63/3ph, 1 x 32/3ph
- Coffee and tea making facilities
- Catering provided as required, price on request
- High-speed internet access and separate guest wi-fi (150MB up / 150MB down)
- Guest and disabled toilet access
- Parking onsite – 24 spaces

Studio Crew

- Brompton Specialist
- LED Technician
- Disguise Operator
- Studio Manager

Tech and Hardware

- LED wall, customisable upon request
- ROE Diamond 2.6mm LED rear walls
- ROE Carbon 5.7mm height-adjustable LED ceiling
- Pixel pitch: 2.6mm for the rear wall, 3.5mm / 5.7mm ceiling & dollies, 3.7mm for reflections, and 5.7mm for lighting
- Brompton 4K processing
- Optical and IR camera tracking options
- Disguise/Unreal based virtual production pipeline (RX units)

SHOT ON SITE AT
VIRTUAL PRODUCTION
STUDIOS BY 80SIX



**100% SHUTTERSTOCK
RSA FILMS 2021**

100% Shutterstock
Winner: Best use of
Virtual Production
at Ideas Awards

APA

DP Andreas Neo



**FIREWORKS
DNEG 2021**

WHILE THE REST OF US DIE 2
VICE TV 2021. LEXHAG VFX, OCTOBER





MAN VS BEE
NETFLIX 2021



DP Tony Slater, BSC

ALAN WALKER
XR SHOW FOR NIO DAY



02

Off Site Virtual Production Studios

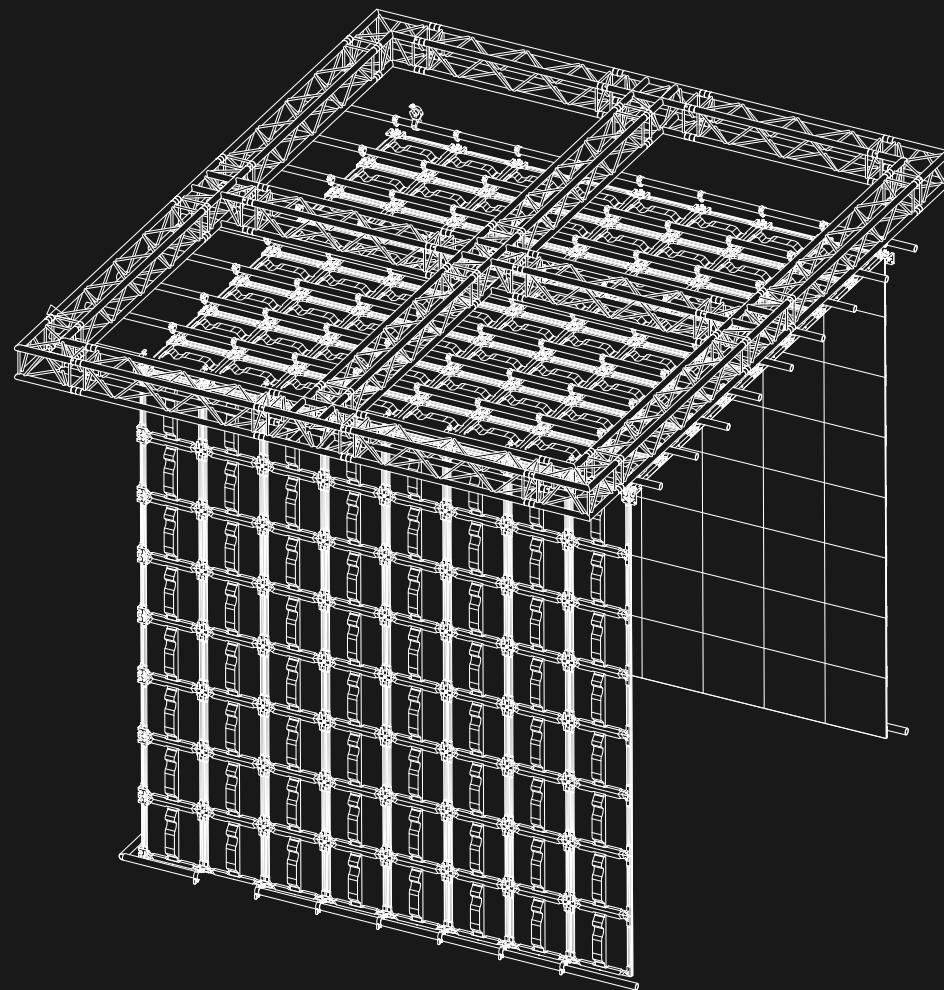

Expert, Custom-Built LED Volumes at Any Scale - Anytime, Anywhere.

Quotation upon request.

02: Off Site VPS

Have your virtual production stage at any location, whether that's off-site or another studio location.

Our custom-build approach means you can have the same configuration as our studio or scale up to whatever extension size and design you require. Pricing includes consultancy, build, system integration and support.

No matter the length of your project, 80six will fully commit to drive technical excellence for your business.

Our team comprised of some of the best industry professionals from video technology and product specialists to project managers, video system engineers, CAD technicians and software specialists will support you during the whole duration of your project:

- Temporary / project-based installs
- Semi-permanent builds
- Long-term leases

Temporary / Project Based Builds

Ideal for projects lasting a few days or weeks. In as little as 1-2 days the 80six team can build an LED volume in a desired location or space. This includes the install of hardware and software for your virtual production set up and a workflow that suits your individual production needs.

This package provides an agreed level of project and technical support during with the same SLA to dismantle as the build.

- Commercial / Advertising
- Corporate Events
- Independent Filmmaking
- R&D
- Broadcast / Sports
- Sequences within a feature or episodic

Semi-Permanent Installs

A longer-term investment in a fixed space for jobs that need a volume for a few weeks or months. As well as the stage design and technical drawings we offer preferential consultancy to clients who wish to trial a variety of stock, product training and ongoing technical support throughout the production. From start to finish we are your systems integrator working as an extension of your team.

- R&D
- Education
- Feature Films
- Episodic Series
- Virtual Production 'test bed' for Studios, Rentals and Production Services
- Lengthy productions and/or projects

Long-Term Lease

This package provides an economic way of investing in a LED stage with greater expansion capabilities and lower financial risk. As an independently owned business we can proactively review options to future proof your virtual production services should you wish to upscale and/or upgrade after the contractual period.

As your technology partner we will work with you from design to install to deliver uniquely tailored virtual production services and world class technical video solutions that suit your business aspirations and needs.

- R&D
- Education
- Film Studios
- Production Facilities

BUILT OFF-SITE BY 80SIX

GUNSLINGER
2020



INNOVATION LAB
EPIC GAMES 2020



MARS STUDIOS
2020

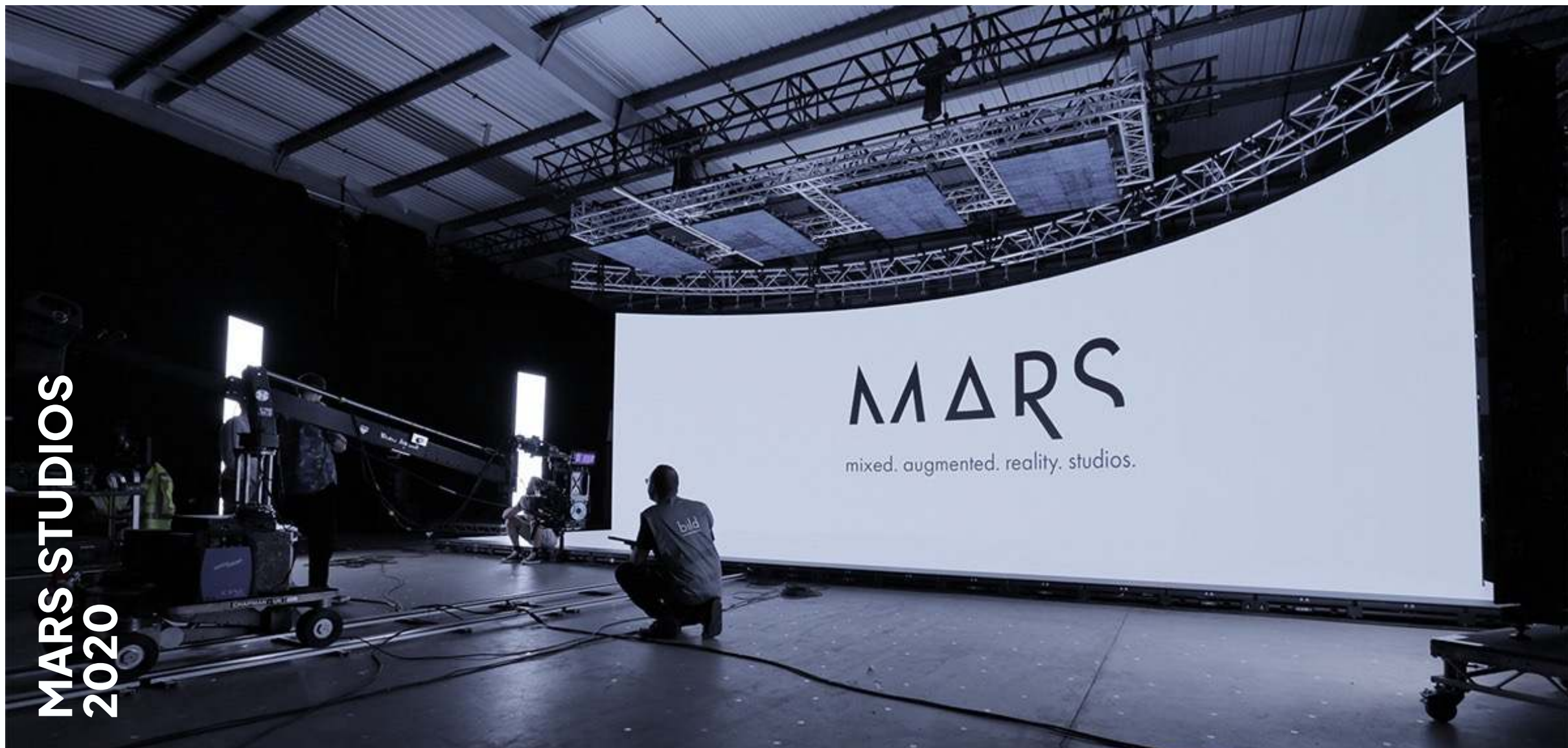

NOTTING HILL CARNIVAL 2020
MALCOM RYE STUDIOS



"80six was the natural choice for our project, having seen other ground-breaking and research-focused projects such as 'Fireworks'. We had chatted a while back at one of 80six's open days, and it's clear they're focused on future workflows, and making this paradigm accessible to all. In three days, we were able to integrate and evaluate a complex, ambitious and entirely new In-Camera VFX configuration for 'Comandante', and start shooting with it. When we talked to 80six, they immediately understood the vision we were looking to achieve, and made sure we were ready to roll the moment we turned up on day 1. When we hit any issues, the welcoming and helpful staff solved them effortlessly. What was great was 80six' attitude, nothing was impossible.

"What I really enjoy about the set up at your virtual production studios is the flexibility. You've done a clever thing by being able to reconfigure it - I can have it with a ceiling, without a ceiling, remove or add LED panels, I can have built straight or curved, so there are infinite technical possibilities. I don't want to walk in and just have one curved wall, how most of the studios have, it's limiting. Some DPs think they will instantly have to understand the VP technology, but you don't necessarily need to know the backend for virtual production. I like technology, but from a cinematographers' point of view, you could almost put a virtual production stage back into the way traditional lighting works. Just think about the Volume as lit panels of which you have 100% control of".

"An important consideration with virtual production is knowing how to incorporate hard lights with the soft light emitted by the LED panels. You really need to understand the environment before you turn up to the set. What we did for 100% Shutterstock was to have a session before where I pre-lit the virtual environment with the director and the Unreal Engine artist to understand the position of the sun. Therefore we started with a solid lighting plan knowing how to introduce our hard light element for daylight exteriors to sell the effect of the sun, matching shadows in foreground, midground and background."

Dan Ring **Head of Research**

*The Foundry
Comandante - feature film by Edoardo
de Angelis*

Andreas Neo

*Director of Photography
100% Shutterstock Commercial*

Brett Danton

*Director of Photography
Virtual Production Discovery Days*

MEET YOUR EXTENDED TEAM



DAN HAMILL
CO-FOUNDER &
COMMERCIAL DIRECTOR



JACK JAMES
CO-FOUNDER &
OPERATIONS DIRECTOR



PAUL NICHOLLS
HEAD OF VIRTUAL PRODUCTION
& REAL-TIME TECHNOLOGY



MICK JONES
PROJECT DIRECTOR



AURA POPA
MARKETING MANAGER



BEN ANNIBAL
PROJECT MANAGER

How to Find Us

The studios are located at our Headquarters in Slough, Berkshire, only a 15-minute train journey from London Paddington station or a 10-minute drive from Junction 5 on the M4, and a short walk from Slough train station.

Our premises are based on a secure gated business park with parking for up to 37 cars. There are several hotels (including brand new Moxy and Residence Inn Hotels), shops and restaurants just a few minutes away.

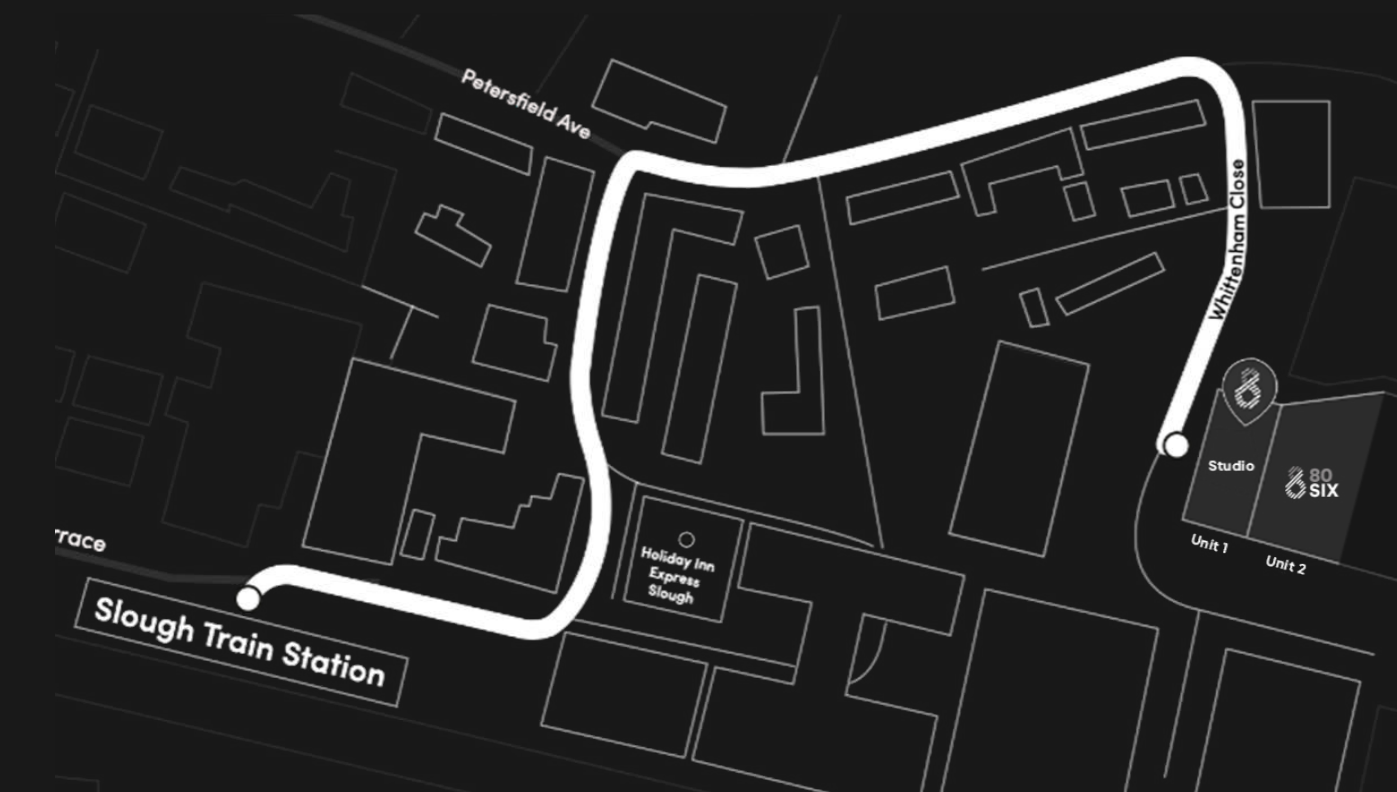

Units 1 & 2

Slough Interchange Industrial Estate, Whittenham Close, Slough, Berkshire SL2 5EP

Contact Us



80-six.com
virtualproductionstudios.com
0333 5777 899
info@80-six.com

Unit 1
Slough Interchange
Whittenham Close
Slough SL2 5EP