

DEADBOLT EDITION



PGD728WE1

Lockly Secure Pro 2025 Version

Setup and Use

LOCKLY
Enjoy the freedom™



We're here to help

Your Lockly smart lock includes lifetime support. If you get locked out, have any issues, or want to share feedback, just contact us, and we'll help you quickly.

 **(669) 500-8835**

 **help@lockly.com**

 **support.lockly.com**

Setup

App Download	03
Install Battery	04
Lock Overview	05/6
Enter Program Mode	07
Fingerprint Access	08
Adding a Fingerprint	09
Adding a PIN Code	10

Download the Lockly Home app

Scan or visit [Lockly.com/app](https://lockly.com/app)



The Lockly Home app will guide you through final installation, setup, and creating your user profile for a more tailored and optimized experience.

Install Battery and Start Self-check

Ensure the batteries are full.

Install battery as shown.

Perform self-check (skip if done)
Immediately hold the red program button for 4 seconds. The lock will perform a self-diagnostic by extending and retracting the deadbolt multiple times.

Open the Lockly Home app and tap (+) to add a new device. Locate your Lockly model and follow in-app instructions to continue setup.

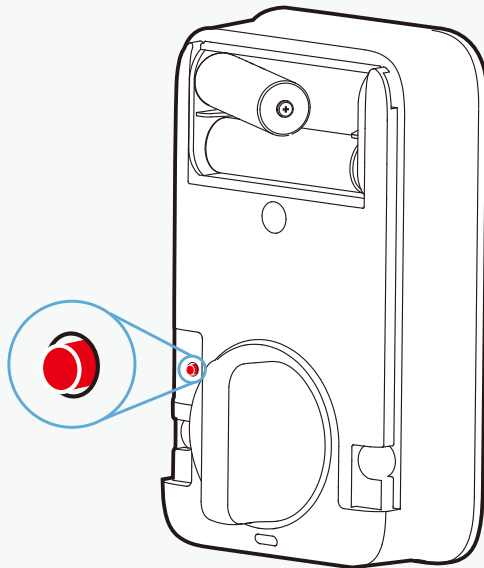

Getting to know your Lockly Secure Pro

Exterior

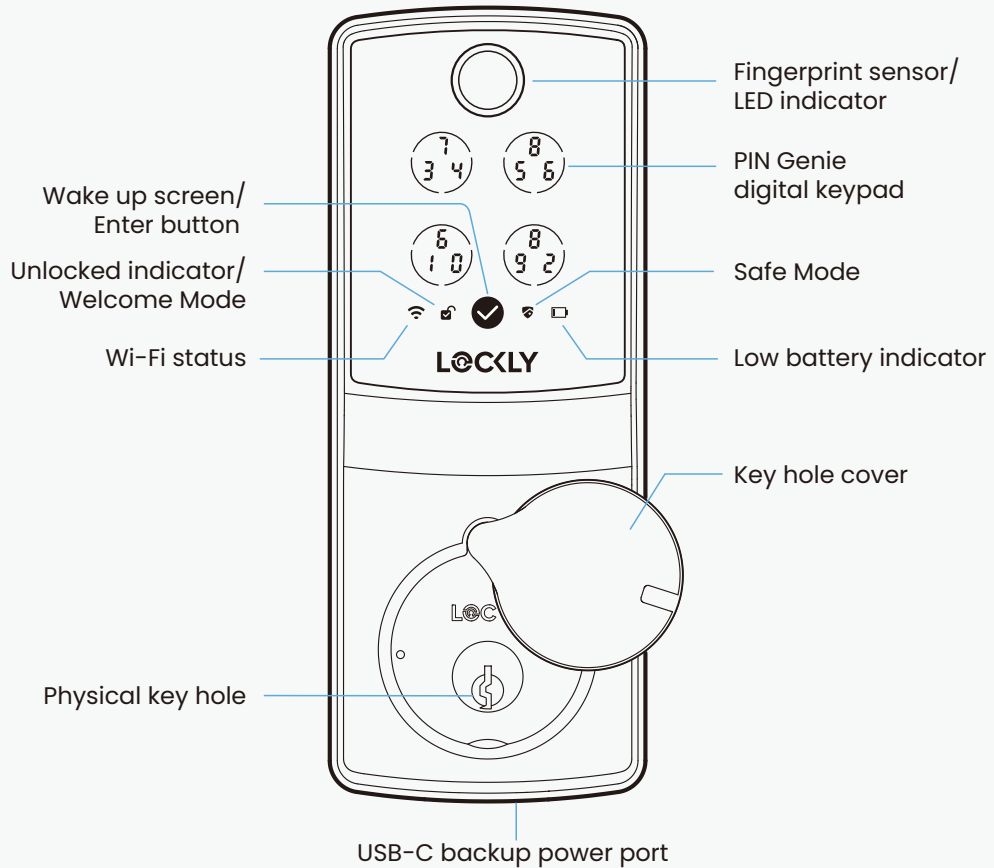

Interior

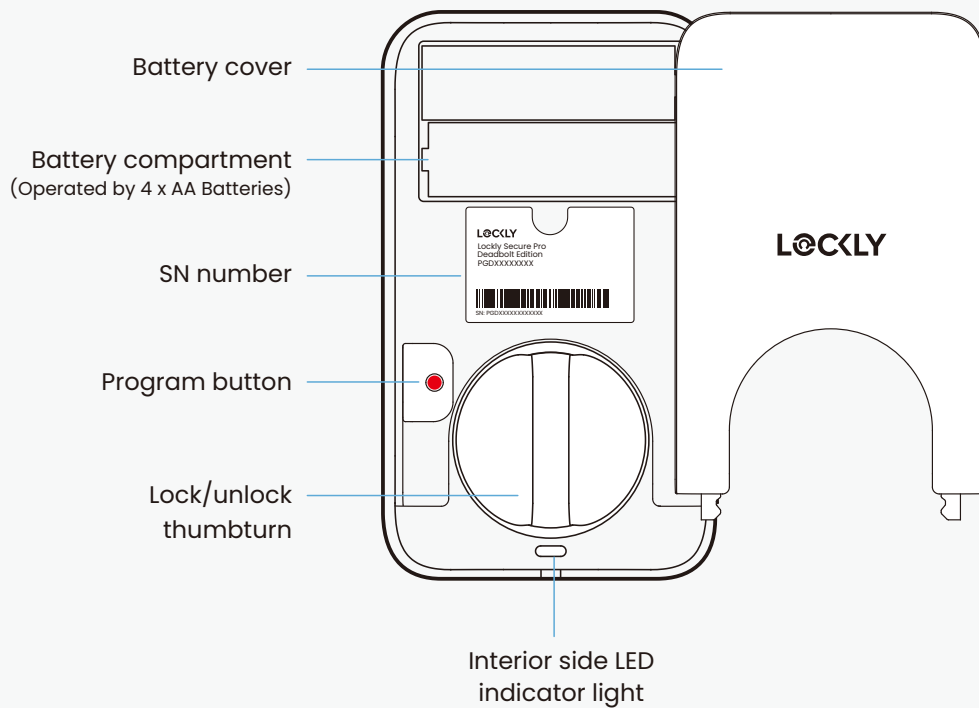

Entering Programming Mode

To enter **Programming Mode**, remove the battery compartment cover on the interior side of the Secure to expose the **Program** buttons.

Simply press the **Program** button to enter programming mode.

To end **Programming Mode**, press the **Program** button anytime. **Programming Mode** will automatically exit if the keypad is inactive for more than thirty (30) seconds.

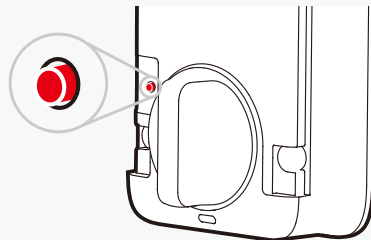

Number	Mode
8L	Pairing Bluetooth
RE	Reset

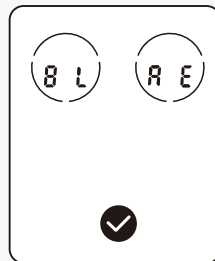

When you actively turn off WiFi/Bluetooth through super power saving or custom power saving, you cannot turn on WiFi/Bluetooth again through the app. You need to manually press the Program button to temporarily turn on WiFi/Bluetooth. After 5 minutes of timeout, WiFi/Bluetooth will be automatically turned off.

If you need to reset, you must have your **Activation Code** available. The **Activation Code** can be found on the **Activation Code Card** that came with your smart lock. Once the smart lock has been reset, all the data previously stored will be deleted. See below which Reset procedure applies for you.

Direct Reset

Press the Program button briefly, then select the **RE** menu on the menu interface and enter the Activation Code. Confirm by pressing the confirmation button to perform the reset.

Reset via Lockly Home app

In the Lockly Home app, navigate to the Settings menu and choose 'Perform Factory Reset'. The smart lock will restart and reset itself. After the reset, you will need the Activation Code to reconnect with the app.

Set Up Fingerprint Access

Fingerprint Scanning

For fast and reliable fingerprint recognition, it's important to follow correct finger positioning when registering your fingerprints.

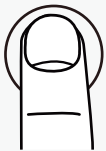

Alignment

Avoid positioning finger too high or low on the sensor.

Avoid positioning finger too much off-center left or right.



Angle

Keep finger straight and somewhat flat; avoid holding at an angle.

Adding a Fingerprint

In the Lockly Home app, choose your lock then select "Access" and follow on-screen instructions.

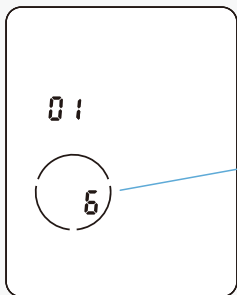

Scanning process

Your finger will be scanned six times for optimal accuracy. The countdown shows in the lower-left circle of the digital screen, starting from six.

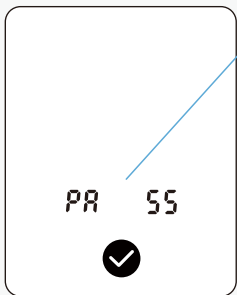

Place your finger on the sensor and hold still until you hear a beep. Slightly adjust your finger position and hold for each remaining scan until you hear a longer beep with the word "pass" indicating a successful scan.



If fingerprint registration fails, repeat process.

Adding Additional Access Codes

Access code types

Set permanent, recurring, time-based, or one-time use access codes.



Default PIN code

The default PIN code is 1 2 3 4 5 6.

During setup, you will be prompted to set a new code to replace it.

Adding a code

Select your lock from the Lockly Home app, then select **Access** then **user**, **Access Code** and follow the on-screen instructions to setup the various types of codes.

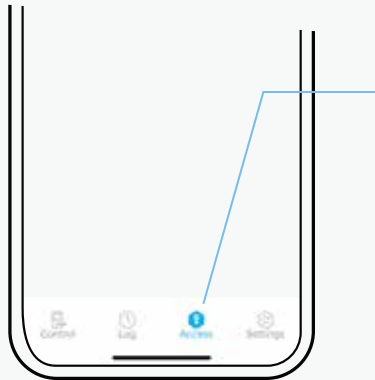

Your new Lockly **Access Code** can be any combination of **6 to 8 digits**. Once a new Access Code is entered, the **Default Access Code** of 123456 would be deleted. A maximum of 52 sets of Access Codes can be stored for use at any given time. To add more than 52 sets of Access Codes, you must delete an existing Access Code before adding a new code.

There are different types of Access Codes that can be generated using the Lockly Home app. Each type of access code have different levels of permission you can select for your guests, tenants, deliveries, helpers, etc., Get the latest updates on access codes, visit: support.lockly.com/faq/accesscodes/

Use

Unlock with Keypad	12
Fingerprint Access	14
Unlock with App	15
Auto and Manual Lock	16
More Ways to Access	17/18
Safe Mode	19
Rain Mode	20
Alert and Sounds	21
Troubleshooting/FAQs	23/24

Unlocking Using Access Codes

How to Use the Keypad

There are a total of **five (5) buttons** on the keypad as shown in the example image to the left. The numbers in each button may differ than what is shown on your device than what is displayed here.

To enter your required digit, just simply press the circle where your number is shown. You do not need to press the actual number as anywhere within the circle will suffice.

The button on the bottom is the **enter button**. You will be pressing this button when you are done entering your **Access Code**.

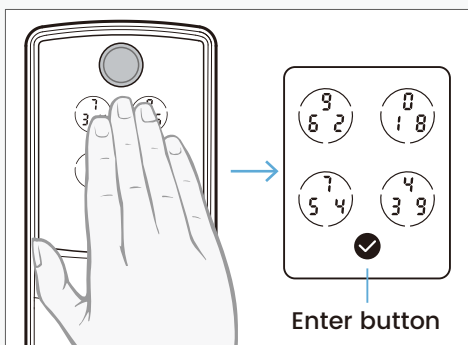

Slide your hand across the screen to activate the keypad.

Enter your **6 to 8 digit Access Code** followed by the enter button. Press enter button anytime to reset if you entered the wrong digit.

If the **Access Code** entered is correct, the door will unlock. If the **Access Code** entered is incorrect, LED indicator will **flash red light**.

Note: the default PIN code is 1 2 3 4 5 6



Ten consecutive wrong attempts will put Lockly in “Safe Mode”.

You may toggle between two types of keypad displays to enter your **Access Code**. The **fixed digit** version and the **PIN Genie** version (Recommended). Press and hold the **Enter Button** for 3 seconds to toggle back and forth between the two keypads. *(Sample display shown only)*

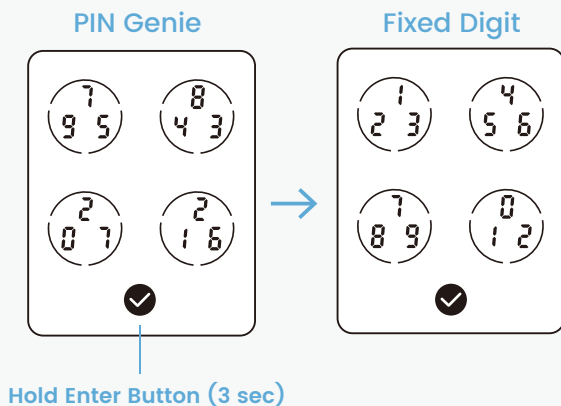

Temporarily boost screen brightness by pressing and holding any of the 4 circular number buttons for 3 seconds.

Unlock with your finger

Featuring advanced AI learning technology.

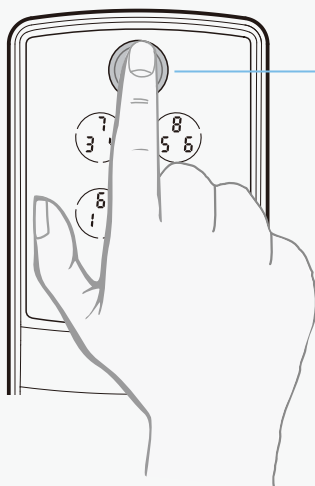

Place a registered finger flat and centered on the sensor.

Green circular LED: with a beep; door is unlocked.

Red circular LED: with two beeps; finger not recognized. Try again or try another registered finger.



Our advanced biometric sensor with AI learning technology recognizes your fingerprint in 0.2 seconds and improves in speed and accuracy with use.

Locking/Unlocking Using App

Lock, unlock, and check status.

Unlock or lock

Choose your lock in the Lockly Home app, tap unlock or lock.

Remote app control

Unlock, lock, check status, and get notifications from anywhere on your smartphone.

History and status monitoring

Check real-time status and history on your smartphone.



Auto and Manual Locking

When unlocked the  icon will appear on screen.

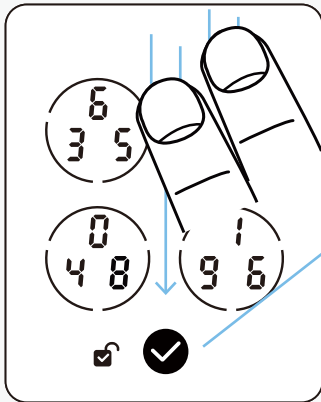

Auto-locking

In the Lockly Home app, set your desired time (example 5-min) under settings of your lock, **auto-lock timer**.

Lock using digital screen

Swipe top to bottom with two fingers when screen is off or press the enter button when screen is on.

Interior locking

Rotate the thumbturn on the interior assembly.

Lock with key

open the key cover by sliding the cover on either left or right direction to reveal the **keyhole**, insert physical key and rotate.



You can set auto-lock timing under your lock's setting in the Lockly Home app.

More Ways to Access and Control

Secure access, control, and monitoring options.



eKeys and eBadges

Share one-time, permanent, recurring, or revocable access with people you trust.



Voice control

Unlock, lock, or check door status through Amazon Alexa, and Google Assistant.



Offline Access Codes™

Grant one-time access through the Lockly Home app without needing an internet connection.



Welcome Mode

Temporarily keep your lock from auto-locking for more convenient trusted user access.



We introduce new features every year. Subscribe to our newsletter at lockly.com for product updates, tips, and the latest innovations.

More Ways to Access and Control



History and status monitoring

Check real-time status and history on your smartphone.



Air Transfer

Easily transfer user profiles between Lockly device for seamless setup and access management.



Set up user privileges

Grant sub-admin privileges to allow others to manage your property.



Manage multiple properties

Manage access control and reporting with LocklyOS, the cloud platform for property access management.

For more information, refer to the Lockly Home app or visit [support.Lockly.com](https://support.lockly.com).

Safe Mode – Overview

Lockly will enter **Safe Mode** when ten (10) consecutive wrong **Access Codes** are entered within 10 minutes. When in **Safe Mode**, the lock status icon  will start to flash.

You will see a “30” on the screen, notifying the number of minutes that the keypad is disabled for. After **30 minutes**, you may attempt to enter the correct **Access Code** to unlock the door.

You can unlock the door and exit Safe Mode by using your correct fingerprint, the app, the indoor lock knob, or a physical key.

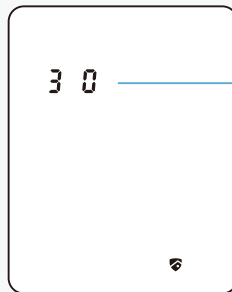

Countdown Prompt
(Displayed in Minutes)

Will start with 30 and
countdown until 0.

Rain Mode

Like other digital electronic products water can trigger to activate the touchscreen and fingerprint sensor which may cause the batteries to drain. To protect the lock and extend battery life, you can setup your Lockly to enter Rain Mode to shut off keypad and fingerprint reader whenever rain or water is detected.

Activate this feature on the Lockly Home app. While you are within the Bluetooth range or remotely connected thru Wi-Fi hub, go to **Settings > Rain Mode** and toggle the button  to turn ON.





When RAIN MODE is ON, the keypad and fingerprint sensor cannot be used. Unlock via Lockly Home app, physical key, or voice control with Amazon Alexa or Google Assistant-enabled devices. Rain Mode auto exits every 30-mins and re-enters if water or rain is still present.

If you are using the Lockly Home app, you will be notified when Lockly entered rain mode and it will be recorded in your access history.

If you have not yet connected your device to Lockly Home app, follow below steps to activate the rain mode feature:



RAIN MODE ON

1. Long press  to enter fixed digit keypad.
2. Enter **access code +234+** .

example: 135790 + 234 + 

3. You will hear a short beep and LED indicator flashes green once Rain Mode is ON.

RAIN MODE OFF

1. Long press  to enter fixed digit keypad.
2. Enter **access code +890+** .

example: 135790 + 890 + 

3. You will hear a long beep and LED indicator flashes green once Rain Mode is OFF.

Alerts and Sounds

Exterior Assembly Alerts

Fingerptint

Exterior LED indicator flashes green with a 'beep' sound

Door unlocked

Exterior LED indicator flashes red with two 'beep' sounds

Fingerprint recognition failed

Access Code

Exterior LED indicator flashes green with a 'beep' sound

Door unlocked

Exterior LED indicator flashes red with two 'beep' sounds

Incorrect access code entered

Voice Control

Exterior LED indicator flashes green

Door unlocked

Interior Assembly Alerts

Battery

Interior LED indicator flashes red with a beep sound (x3)

Battery level is less than 20%

Interior LED indicator flashes red with a beep sound (x5)

Battery level is critically low (3 unlocks remaining). Charge battery immediately.

Troubleshooting FAQs

Troubleshooting/FAQs

Why is my keypad not responding?

- If  is flashing, your smart lock is in **Safe Mode**. Unlock with other access credentials (fingerprint, mobile app, or physical key) to exit.
- If water is detected, **Rain Mode** may be activated. Unlock your door with other authentication methods (Lockly Home app..)
- Check if batteries are installed correctly.
- Refer to [support.Lockly.com](https://support.lockly.com) for more information about **Safe Mode** and **Rain Mode**.

Why is my keypad on full blackout?

- Battery may have been completely depleted. Use the physical key or a Type-C cable to connect your Lockly to a mobile power source to temporary activate the lock. Replace the battery immediately after unlock.

Why is my fingerprint not recognized?

- Check that you are using a registered finger.
- Make sure your finger is clean and dry.
- Position your finger at the centre of the sensor.

Why is my Lockly not locked automatically?

- Check if auto lock is disabled in the Lockly Home app.
- **Welcome mode** is currently active. Disable or change setting in Lockly Home app.

How to pair my smart lock with a new phone?

- Download the Lockly Home app on your new device and log in using the same account credentials, follow in-app instructions.

How to pair my smart lock with a new Lockly account?

- You will need to perform a factory reset with the following steps.
 1. On the old Lockly Home app account, go to Settings > Reset and Pairing > Perform Factory Reset
 2. Download, register and log in to the new Lockly Home app account. You will need your activation card to set up the device.
- You can perform factory reset on the lock. Refer to Lockly Home app or support.Lockly.com for more details.

Lockly Technical Support

(669) 500-8835

help@Lockly.com

support.Lockly.com

FCC Warning

This device complies with Part 15 of the FCC Rules. Operation is subject to the following two conditions: (1) This device may not cause harmful interference, and (2) this device must accept any interference received, including interference that may cause undesired operation.

NOTE 1: This equipment has been tested and found to comply with the limits for a Class B digital device, pursuant to part 15 of the FCC Rules. These limits are designed to provide reasonable protection against harmful interference in a residential installation. This equipment generates, uses, and can radiate radio frequency energy and, if not installed and used in accordance with the instructions, may cause harmful interference to radio communications. However, there is no guarantee that interference will not occur in a particular installation. If this equipment does cause harmful interference to radio or television reception, which can be determined by turning the equipment off and on, the user is encouraged to try to correct the interference by one or more of the following measures:

- Reorient or relocate the receiving antenna.
- Increase the separation between the equipment and receiver.
- Connect the equipment to an outlet on a circuit different from that to which the receiver is connected.
- Consult the dealer or an experienced radio/TV technician for help.

NOTE 2: Any changes or modifications to this unit not expressly approved by the party responsible for compliance could void the user's authority to operate the equipment.

FCC Radiation Exposure Statement

This equipment complies with FCC radiation exposure limits set forth for an uncontrolled environment. It should be installed and operated with a minimum distance of 20cm between the radiator & your body.



WARNING: This product can expose you to chemicals including Lead, which is known to the State of California to cause cancer. For more information go to www.P65Warnings.ca.gov.

Let's co-create together!

Have an innovative idea?
Need a new solution for a situation?

Let us know. We are always innovating based
on customer input and feedback.
(669) 500-8835 or hello@Lockly.com

Own a business?

Learn about how LocklyPRO and LocklyOS
can help you in your business.

(510) 288-9928 or prosales@Lockly.com



© Copyright 2025 Lockly All rights reserved

Patent No. US 9,881,146 B2 | US 9,853,815 B2 | US 9,665,706 B2 | More patents refer to <https://lockly.com/pages/our-patents>
The Bluetooth® word mark and logos are registered trademarks owned by the Bluetooth SIG, Inc., and any use of such marks by Lockly is under license. Other trademarks and trade names are those of their respective owners. Google, Android, Google Play and Google Home are trademarks of Google LLC., Amazon, Alexa and all related logos are trademarks of Amazon.com, Inc., or its affiliates.

© Copyright 2025 Lockly All rights reserved.
(See details on the inside back cover).