



Introduction

Your GuardianMPS is an advanced safety service you can access through an Android app. Central Station personnel are on hand to help resolve your panic alarms and monitor any timed safety checks you set up.

Once installed, the app will continuously run in the background while your device is switched on.

This guide will introduce you to the main features of the service.



Panic Alarm

If you get into difficulty you can request emergency assistance as follows:



Repeatedly press your cell phone power key, 5 times, in 5 seconds. Your phone will vibrate to let you know it is connecting. Your screen will black out to ensure the alarm is covert.



Background audio recording will be made available to Central Station who will take steps to ensure your safety and get you help.



Alternatively you can press and hold the panic button within the app which will respond in the same way.

Setting up a safety check: Text based



Click the Clock icon on the app's main screen.



Enter task details, leave an address and ZIP if you can.



Set your Safety Check duration.



Click Send to check in.



You can view your status on the app's main screen.

Check out or edit a safety check: Text based



Click the app's Clock icon.



Choose Edit or Check Out.



Check Out: Ends your current task.
Edit: Modify your task details and remaining time.



Click Send or OK as prompted.



The main screen will reflect any changes you make.

Set up a Safety Check: Call based



Click the Phone Icon on the app's main screen.



Key in your 4 digit PIN.



When prompted SPEAK your task details, including an address and ZIP code.



When prompted KEY IN your expected duration in minutes, e.g. 60 = 1 hr.



WAIT for acknowledgement, and hang up.

Check out or edit a safety check: Call based



Click the Phone Icon on the app's main screen.



Key in your 4 digit PIN



Press the Pound key to check out of your task.



To EXTEND press star, and KEY IN how many minutes you need.



Automated Safety Verification Calls

If a Safety Check overruns GuardianMPS will:

- Give 5 minutes grace.
- Call to check you are safe.
- Give a further 5 minutes grace.
- Call to check you are safe.

Central Station will be notified if you don't enter your PIN to confirm your safety.

Tip: Safety Checks still work if your phone is lost, stolen or damaged or you are out of network.

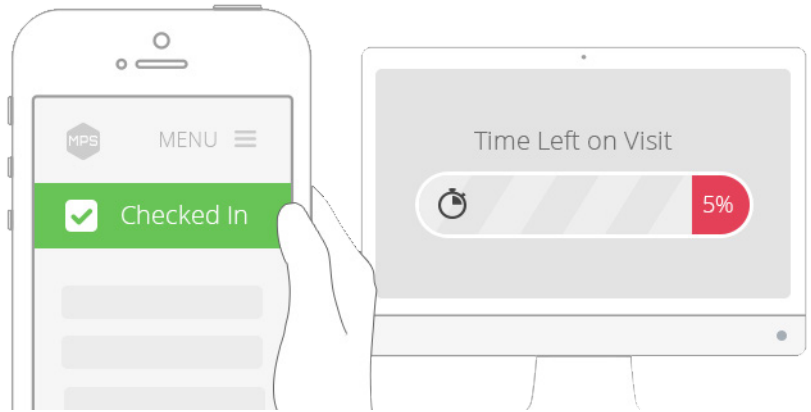

Duress Alarm

Your 4 digit PIN is used to confirm that you are safe during any Safety Verification calls. Entering a PIN of **9999** will activate a duress alarm. You will hear a covert message "Alert cancelled", some audio is recorded and an alarm is sent to Central Station. This feature is useful if you cannot raise a panic Alarm.



In App Help

In any of the app functions there is a help file.

- Press the help icon for further information about each function.

GPS Feature

The app will periodically update GuardianMPS with your GPS location. This is particularly beneficial when dispatching help. You can manually send your location using the main screen's location icon and we recommend you do this before entering buildings.



Press the location icon.



Click Send to update your location information.



Click to toggle between satellite and standard view.



Click to show your location.

